

Instruction Book

Memory Craft 1000

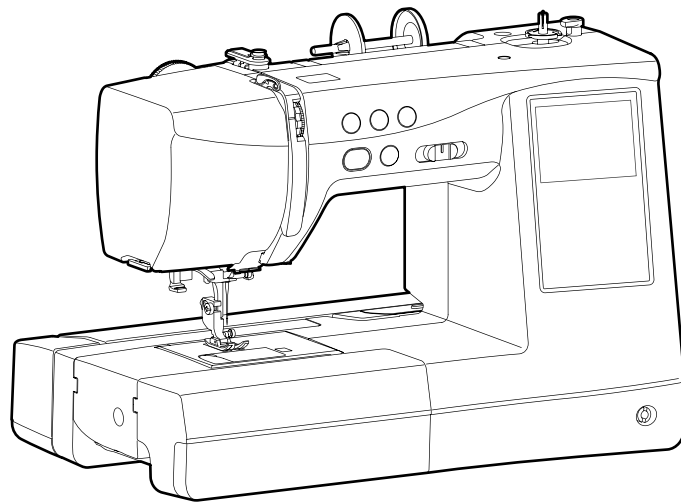

IMPORTANT SAFETY INSTRUCTIONS

When using an electrical appliance, basic safety precautions should always be followed, including the following:

This sewing machine is designed and manufactured for household use only.

Read all instructions before using this sewing machine.

DANGER— To reduce the risk of electric shock:

1. An appliance should never be left unattended when plugged in. Always unplug this sewing machine from the electric outlet immediately after using and before cleaning

WARNING— To reduce the risk of burns, fire, electric shock, or injury to persons:

1. Do not allow to be used as a toy. Close attention is necessary when this sewing machine is used by or near children.
2. Use this appliance only for its intended use as described in this owner's manual. Use only attachments recommended by the manufacturer as contained in this owner's manual.
3. Never operate this sewing machine if it has a damaged cord or plug, if it is not working properly, if it has been dropped or damaged, or dropped into water. Return this sewing machine to the nearest authorized dealer or service center for examination, repair, electrical or mechanical adjustment.
4. Never operate the appliance with any air opening blocked. Keep ventilation openings of this sewing machine and foot controller free from accumulation of lint, dust and loose cloth.
5. Never drop or insert any object into any opening.
6. Do not use outdoors.
7. Do not operate where aerosol (spray) products are being used or where oxygen is being administered.
8. To disconnect, turn all controls to the off ("O") position, then remove plug from outlet.
9. Do not unplug by pulling on cord. To unplug, grasp the plug, not the cord.
10. Keep fingers away from all moving parts. Special care is required around the sewing machine needle and/or cutting blade.
11. Always use the proper needle plate. The wrong plate can cause the needle to break.
12. Do not use bent needles.
13. Do not pull or push fabric while stitching. It may deflect the needle causing it to break.
14. Switch this sewing machine off ("O") when making any adjustment in the needle area, such as threading the needle, changing the needle, threading the bobbin or changing the presser foot, and the like.
15. Always unplug this sewing machine from the electrical outlet when removing covers, lubricating, or when making any other adjustments mentioned in this owner's manual.

SAVE THESE INSTRUCTIONS

For Europe only:

This appliance can be used by children aged from 8 years and above and persons with reduced physical, sensory or mental capabilities or lack of experience and knowledge if they have been given supervision or instruction concerning use of the appliance in a safe way and understand the hazards involved. Children shall not play with the appliance. Cleaning and user maintenance shall not be made by children without supervision.

For outside Europe (except U.S.A.):

This appliance is not intended for use by persons (including children) with reduced physical, sensory or mental capabilities, or lack of experience and knowledge, unless they have been given supervision or instruction concerning use of the appliance by a person responsible for their safety. Children should be supervised to ensure that they do not play with the appliance.



Please note that on disposal, this product must be safely recycled in accordance with relevant National legislation relating to electrical/electronic products. If in doubt please contact your retailer for guidance. (EEA (European Economic Area) and UK)

TABLE OF CONTENTS

ESSENTIAL PARTS

Names of Parts	4
Standard Accessories	5
Accessory Storage	7
Extension Table	7
Free-arm Sewing	7
Foot Control and Thread Cutter Switch (optional)	8
Adjusting the Thread Cutter Switch Position	8

GETTING READY TO SEW

Connecting the Power Supply	10
Using start/stop button	10
Before using your sewing machine	10
Operating instructions:	10
Using foot control	11
Using optional foot control	12
Using optional thread cutter switch	13
Controlling sewing speed	15
Machine Operating Buttons	16
Touch Screen Keys	17
Help Screen	18
Raising and Lowering the Presser Foot	19
Knee Lifter (optional)	19
Adjusting Thread Tension	20
Adjusting Presser Foot Pressure	21
Dropping the Feed Dogs	22
Replacing the Presser Foot	23
Removing and Attaching the Foot Holder	24
Replacing the Embroidery foot P	25
Replacing the Needle Plate	26
Replacing the Needle	27
Fabric and Needle Chart	28
For Ordinary sewing	28
For Embroidery	28
Winding the Bobbin	29
Removing the Bobbin	29
Setting the spool of thread	29
Extra spool pin	29
Winding the bobbin	30
Inserting the Bobbin	31
Threading the Machine	32
Guide sticker for threading	33
Built-in Needle Threader	34
Drawing Up the Bobbin Thread	35

ORDINARY SEWING MODE

Ordinary Stitch Patterns	36
Utility Stitches	38
Function keys	38
Manual Stitch Settings	40
Altering needle drop position (straight stitches)	40
Altering stitch width (zigzag stitches)	40
Altering stitch length	41
Straight Stitches	42
Sewing from the Edge of Thick Fabric	42
Changing Sewing Direction	43
Securing Seams	43
Needle Plate Guides	44
Turning a Square Corner	44
Straight Stitch Needle Plate	45
Variety of Straight Stitches	46
U1 Straight stitch in center needle position	46

U2 Lock-a-Matic stitch	46
U3 Locking stitch	47
U4 Straight stitch in left needle position	47
U5 Triple stretch stitch	48
U6, U7 Stretch stitches	48
Zigzag Stitches	49
U8, U9 Zigzag stitches	49
U10 Multiple zigzag stitch	49
Overedge Stitches	50
U10 Multiple zigzag stitch	50
U11 Overedge stitch	50
U12 Knit stitches	51
U13 Visible hemming	51
U14 Double overedge stitch	52
U15 Overcasting stitch	52
U16 Hemstitch	53
U17, U18 Blind hemming	54
U19, U20 Shell tuck	55
U21 Attaching elastic	56
U22 Box stitching	56
Zipper Sewing	57
Gathering	60
Pintucking	61
Button Sewing	62
Variable Zigzag	63
Maximum zigzag width adjustment	64
Variable zigzag length adjustment	64

BUTTONHOLES AND SPECIALTY STITCHES

Buttonholes and Specialty stitches	65
Variety of Buttonholes	66
B1 Sensor (Square) Buttonhole	67
Double Layer Buttonhole	69
Altering buttonhole width	70
Altering buttonhole stitch density	70
Other Buttonholes	71
B2, B3 Round end and fine fabric buttonholes	71
B4-B8 Keyhole buttonholes	71
B9, B11 Stretch and antique buttonholes	72
B10 Knit buttonhole	72
B12 Weltd buttonhole (Bound buttonhole)	73
Corded Buttonhole	75
Specialty Stitches	76
B13 Darning	76
B14 Tacking	78
B15 Eyelet	79

DECORATIVE STITCHES

Decorative Stitches	80
Applique	85
Fringing	86
Drawn Work	86
Cross-Stitch	87
Heirloom	87
Smocking	87
Fagoting	88
Scallop	88
Patchwork Piecing	89
Angle scales on the needle plate	89
Q54-Q58 Hand-look quilt stitches	90
Stippling	90

Satin Stitches.....	91
Elongation ratio	91
Bridge Stitches	92
French knots and Candlewick knots.....	92
Clasp Stitch	92

PROGRAMMING A PATTERN COMBINATION

Pattern Combination.....	94
Pattern Combination with a Mirror Image	95
Vertical mirror image (pattern combination)	95
Vertical mirror image (ordinary sewing).....	96
Bridge Stitches	97
Editing a Pattern Combination.....	98
Startover Key.....	100
Preview.....	101

MONOGRAMMING

Pattern Selection Window	103
Programming a Monogram.....	104
Reducing the Size of Letters	105
Spacing.....	105
Twin Needle Sewing.....	106

EMBROIDERY MODE

Embroidery Unit.....	108
Extending the carriage arm	108
Retracting the carriage arm.....	109
Attaching the embroidery foot P.....	110
Thread tension and presser foot pressure	110
Replacing needles.....	110
Replacing the needle plate.....	110
Bobbin holder for embroidery (high tension)	111
Selecting embroidery thread	111
Stabilizers.....	112
Using water soluble stabilizers (non-woven)	113
Embroidery hoops	113
Setting the fabric in an embroidery hoop.....	114
Attaching the embroidery hoop to the machine.....	116
Thread holder	116
Embroidery Mode Window	117
Selecting Built-in Embroidery Designs	117
Design category key.....	117
Design category	117
Home position key.....	118
Selecting Built-in Monograms.....	119
Font category	119
Function Keys for Monograms.....	120
Ready to Sew Window	121
Function keys	121
Pattern information	121
Function Keys for Embroidery	122
Stitch back/forward keys	122
Jump key	122
Color section key.....	122
Trace key.....	123
Hoop back key.....	124
Color list key.....	125
Cross key	126
Jog keys	126
Cutting the tails of jump threads.....	126
Fine position/angle adjustment key	127
Starting to Sew Embroidery.....	128
In-The-Hoop Designs <Rattles>.....	129

Attaching the ribbon	132
Embroidery Lace Designs	133
Butterfly design.....	133
Placement guides for “Embroidery Lace Designs for fabric”	135
Applique Designs.....	136
Fringe Designs	137
Flag Garlands.....	138
Monogramming for Embroidery	139
Programming a monogram.....	139
Monogram placement.....	139
2-Letters monogram	140
Editing a monogram	141
Editing Mode.....	142
Selecting a hoop size	142
Opening the embroidery designs	142
Editing Window Information.....	143
Selecting a pattern	143
Moving a pattern.....	143
Duplicating a pattern	144
Deleting a pattern	144
Zooming in the editing window	145
Resizing a pattern	145
Rotating a pattern.....	146
Flipping a pattern.....	146
Monogramming in an arc.....	147
Grouping patterns.....	148
Corner layout.....	149
Customizing the display colors.....	150
Sewing order	152
Color grouping.....	153
Single color sewing	154
Saving a file.....	154
Free-Arm Embroidery (optional).....	155

SAVING AND OPENING A FILE

Saving a File.....	157
Saving a file in an internal memory (Ordinary sewing)	157
Saving a file on a USB flash drive	158
Creating a new folder (Ordinary sewing).....	159
Deleting a file or folder	160
Rename key and new name key	160
Opening a File	162
Ordinary sewing	162
Embroidery	164
File format	165

CUSTOMIZING MACHINE SETTINGS

Machine Settings Mode.....	166
Machine Settings.....	166
Ordinary Sewing Settings.....	170
Embroidery Settings	173
Language Setting	178
Correcting Distorted Stitch Patterns	179

CARE AND MAINTENANCE

Cleaning the Hook Area.....	180
Cleaning the Thread Path.....	181
Oiling the Machine.....	182
Problems and Warning Signals	186
Troubleshooting	188
Formatting USB Flash Drives	191

STITCH CHART

Ordinary Sewing	193
Monogram	195

DESIGN CHART

Embroidery	198
Embroidery Monogram.....	202

QUICK REFERENCE CHART

Ordinary sewing/Common.....	205
Embroidery	207

ESSENTIAL PARTS

Names of Parts

- (1) Upper thread guide
- (2) Bobbin winding tension disk
- (3) Cover
- (4) Spool holder (large)
- (5) Spool pin
- (6) Hole for extra spool pin
- (7) Bobbin winder spindle
- (8) Bobbin winder stopper
- (9) Thread cutter button
- (10) Visual touch screen
- (11) Needle up/down button
- (12) Auto-lock button
- (13) Speed control slider
- (14) Reverse button
- (15) Start/stop button
- (16) Knee lifter socket
- (17) Extension table (accessory storage)
- (18) Thread cutter/holder
- (19) Face cover
- (20) Thread tension dial
- (21) Thread take-up lever
- (22) Presser foot pressure dial
- (23) Lower thread guide
- (24) Needle clamp screw
- (25) Needle bar thread guide
- (26) Needle
- (27) Zigzag foot A
- (28) Needle plate
- (29) Hook cover release button
- (30) Hook cover plate
- (31) Feed dogs
- (32) Bobbin thread cutter
- (33) Foot holder
- (34) Setscrew
- (35) Lever
- (36) Needle threader lever
- (37) Buttonhole lever
- (38) Needle threader guide
- (39) Carrying handle
- (40) Presser foot lifter
- (41) Carriage arm
- (42) Carriage
- (43) Carriage arm release lever
- (44) Machine socket
- (45) USB port
- (46) Foot control jack
- (47) Power switch
- (48) Ventilation openings
- (49) Handwheel
- (50) Cap

NOTE:

- To carry the sewing machine, hold the carrying handle with your hand, and support the sewing machine with the other hand.
- Sewing machine design and specifications are subject to change without prior notice.

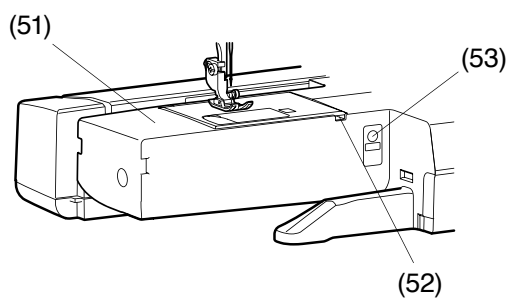

- (51) Free-arm
- (52) Needle plate release hole
- (53) Feed balancing dial

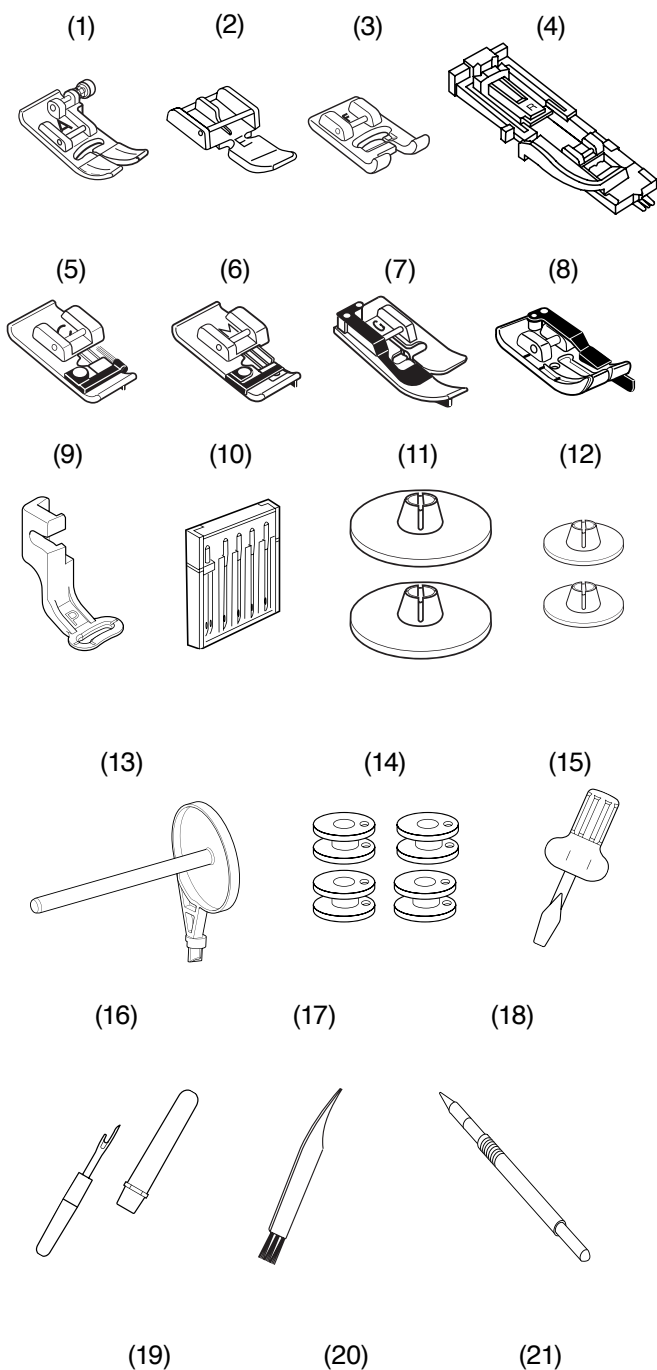

Standard Accessories

No.	Part Name	Part No.
1	Zigzag foot A (Set on the machine)	832523007
2	Zipper foot E	808852003
3	Satin stitch foot F	822804118
4	Automatic buttonhole foot R (in the accessory storage)	753801004
5	Overedge foot C	822801001
6	Overcasting foot M	822808008
7	Blind hemming foot G	825817009
8	1/4" seam foot O	200008037
9	Embroidery foot P	819802105
10	Needle set	820827007
11	Spool holder (large) x 2* (1 is set on the machine)	822020503
12	Spool holder (small) x 2*	822019509
13	Extra spool pin	809041004
14	Bobbin x 4* (1 is set on the machine)	102261103
15	Screwdriver	820832005
16	Seam ripper (Buttonhole opener)	647808009
17	Lint brush	802424004
18	Touch screen stylus	860194002
19	Scissors	803813203
20	Bobbin holder cleaner	859858007
21	Special bobbin holder for embroidery	867513208

* This is the part number for a single item (not for a set).

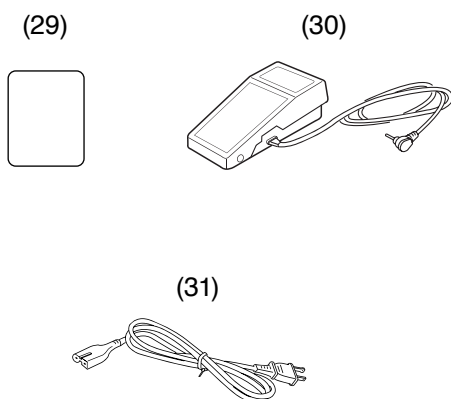
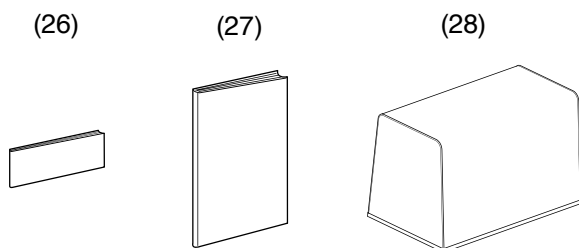
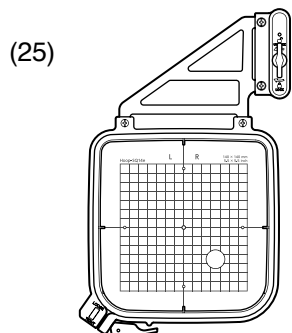
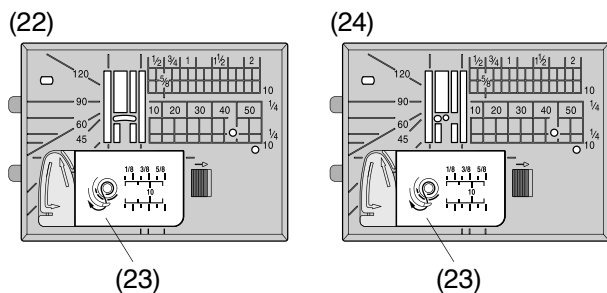

Standard Accessories

No.	Part Name		Part No.
22	Needle plate (set on the machine)		819625009
23	Hook cover plate		809136100
24	Straight stitch needle plate (in the accessory storage)		819803003
25	Embroidery hoop SQ14e (with template)		819801001
26	Stitch reference chart*		819806A01
27	Instruction book		819800000
28	Soft cover		819807007
29	Threading guide sticker		101506A09
30	Foot control		C-1036
31	Power supply cable**	U.S.A. and Canada	856519004
		U.K.	830377008
		Australia	830314018
		Continental Europe	830335004

* Built-in stitch patterns can also be referred on page 193.

** The power supply cable included may differ from the illustration.



Instructional Video

https://www.youtube.com/playlist?list=PLQy563Wz2acvmJUIGFH2GAEKcU_2oYQRP



Template Sheets

<https://www7.janome.co.jp/global/product/machineupdates/template-sheets-for-mc1000/>

Download application for PC



EmbroideryEditor

<https://www7.janome.co.jp/global/product/softwareapps/embroideryeditor-for-new-download/>

* This application is for PC only.

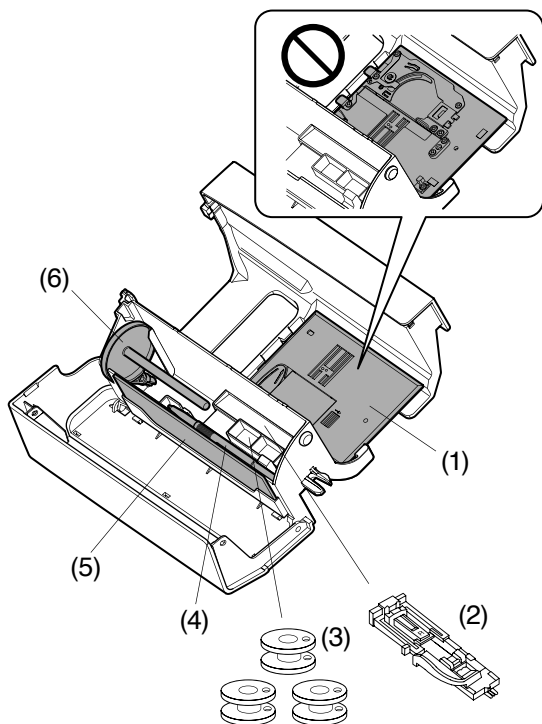
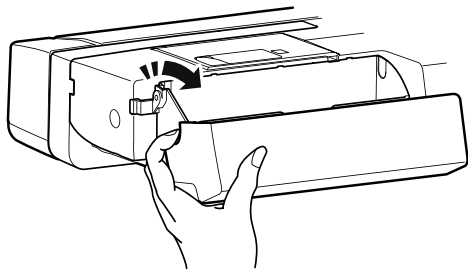

Accessory Storage

The accessories can be conveniently stored in the compartments of the extension table. To store the accessories in the compartment of the extension table, hook your fingers in the hollow on the left side of the extension table. Push up the cover towards you to open the accessory storage.

- (1) Needle plate
- (2) Automatic buttonhole foot R
- (3) Bobbin
- (4) Touch screen stylus
- (5) Stitch reference chart
- (6) Extra spool pin



CAUTION:

Do not place the needle plate upside down otherwise the needle plate may break or cause malfunction.

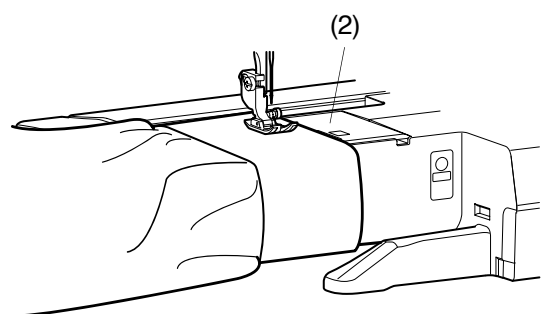
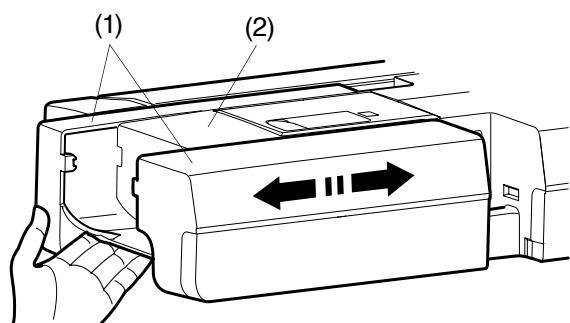

Extension Table

The extension table provides an extended sewing area and can be removed for free-arm sewing.

- (1) Extension table
- (2) Free-arm

To detach:

Draw the table out to the left.

To attach:

Slide the table on the base and push the table to the right.

Free-arm Sewing

Free-arm sewing is used for stitching sleeves, waistbands, pant legs or any other tubular garments. It is also useful for darning socks or mending knees or elbows.

- (2) Free-arm

Foot Control and Thread Cutter Switch (optional)

To attach the foot control and the thread cutter switch to the base plate, tighten setscrews A, and setscrews B with washers as shown.

- (1) Foot control
- (2) Thread cutter switch
- (3) Base plate
- (4) Setscrew A
- (5) Setscrew B
- (6) Washer

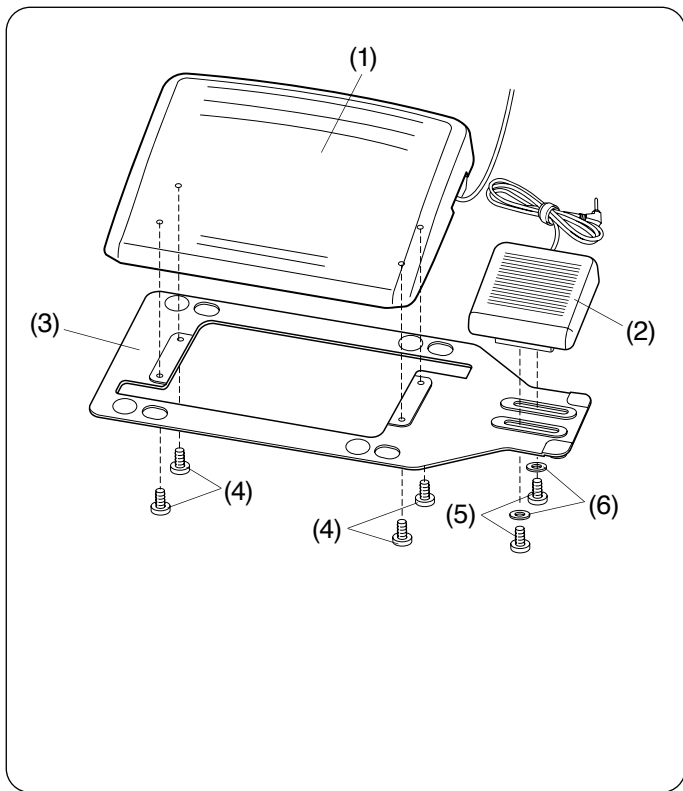

Adjusting the Thread Cutter Switch Position

Placing the thread cutter switch to the left

The thread cutter switch position can be adjusted for your convenience.

If you wish to attach the thread cutter switch to the left side of the foot control, follow the procedure below.

NOTE:

A Phillips head screwdriver is not included with this machine.

1. Remove the setscrews A, B and washers with a Phillips head screwdriver.

- (1) Setscrew A
- (2) Setscrew B
- (3) Washer

2. Turn the base plate 180 degrees.

3. Attach the foot control and thread cutter switch with the setscrews and the washers. Tighten the setscrews A and B. Be sure that the cable is not caught between the foot control and the base plate.

- (1) Setscrew A
- (2) Setscrew B
- (3) Washer

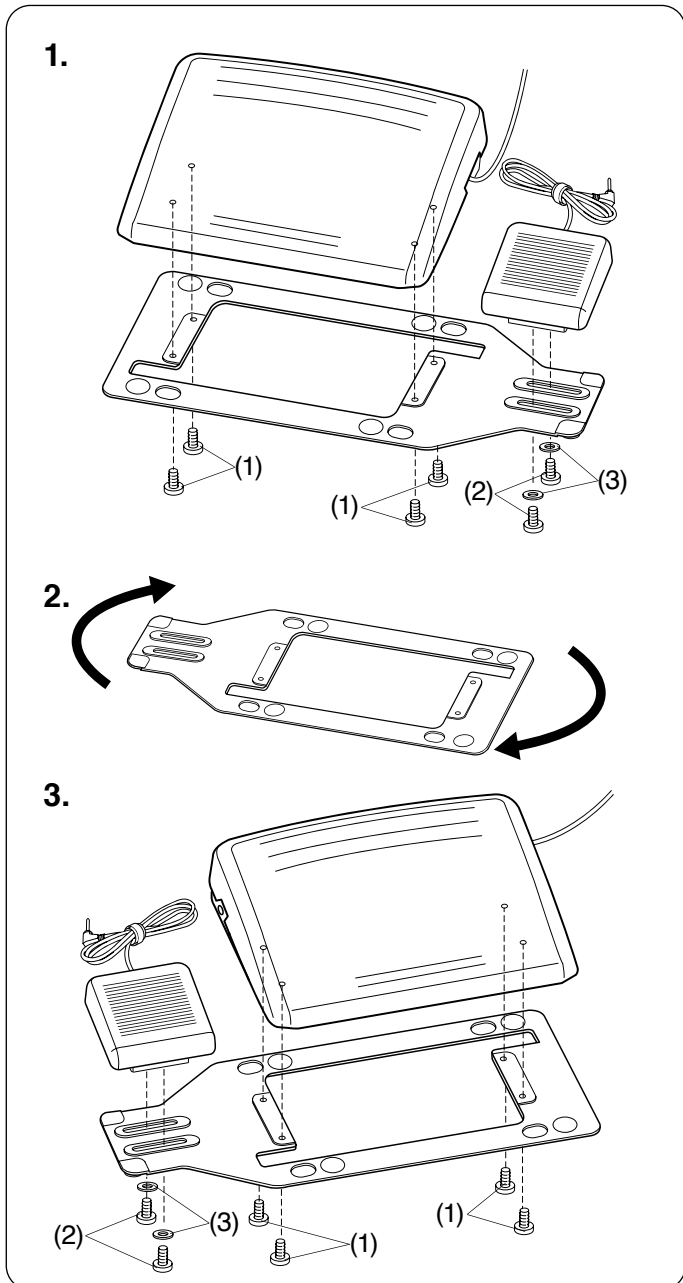

1.

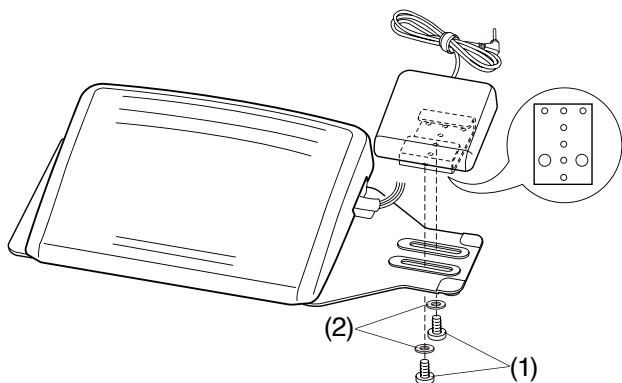

2.

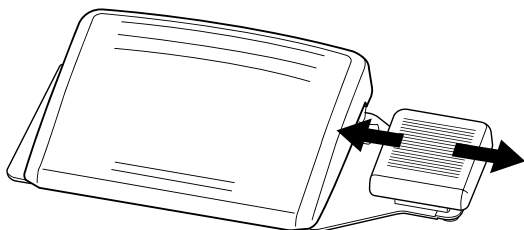

Adjusting the horizontal position of the thread cutter switch

1. Loosen the setscrews B under the switch.

- (1) Setscrew B
- (2) Washer

2. Slide the switch to the left or right, and fix it at the desired position by tightening the setscrews with a screwdriver.

1. 2.

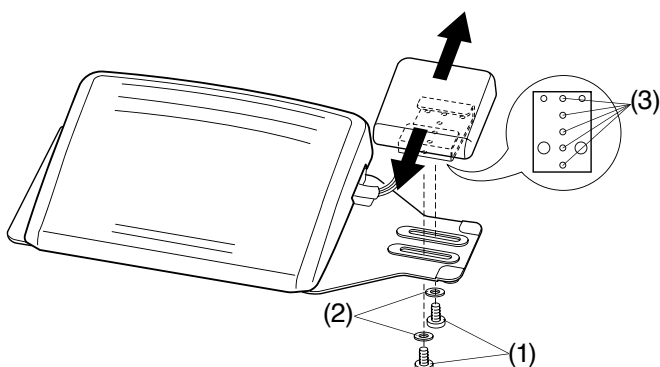

Adjusting the vertical position of the thread cutter switch

1. Remove the setscrews B and washers.

2. Move the switch forward or backward, attach the switch at the desired position and fix it with the setscrews and washers.

- (1) Setscrew B
- (2) Washer
- (3) Desired position

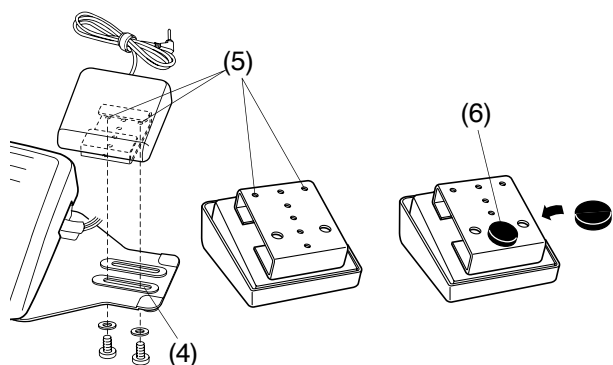

NOTE:

- To fix the thread cutter switch at its lowest position, fix the setscrews B into the hole (4), and then holes (5).
- Tighten the setscrews B securely.
- Peel off the backing paper from the rubber sole (6) and attach it to the bottom of the thread cutter switch as shown.

GETTING READY TO SEW

Connecting the Power Supply

Using start/stop button

1. First make sure the power switch is OFF.
2. Insert the machine plug of the power supply cable into the machine socket.
3. Insert the power supply plug into the wall outlet, and turn the power switch ON.
 - (1) Power switch
 - (2) Machine socket
 - (3) Machine plug
 - (4) Power supply plug
 - (5) Wall outlet

NOTE:

- Make sure to use the power supply cable that came with the machine.
- If you turn OFF the power switch, wait for 5 seconds before turning it on again.

⚠ WARNING:

- While in operation, always keep your eyes on the sewing area, and do not touch any moving parts such as the thread take-up lever, handwheel or needle.
- Always turn OFF the power switch and unplug the machine from the power supply:
 - when leaving the machine unattended.
 - when cleaning the machine.
- Do not place anything on the foot control.

Before using your sewing machine

Before using your sewing machine for the first time, place a scrap of fabric under the presser foot and run the machine for a few minutes.

Wipe away any oil which may appear.

Operating instructions:

The symbol “O” on the switch indicates the “OFF” position of the switch.

For the U.S.A. and Canada only

Polarized plug (one blade wider than the other):

To reduce the risk of electric shock, this plug is intended to fit in a polarized outlet only one way. If it does not fit fully in the outlet, reverse the plug. If it still does not fit, contact a qualified electrician to install the proper outlet. Do not modify the plug in any way.

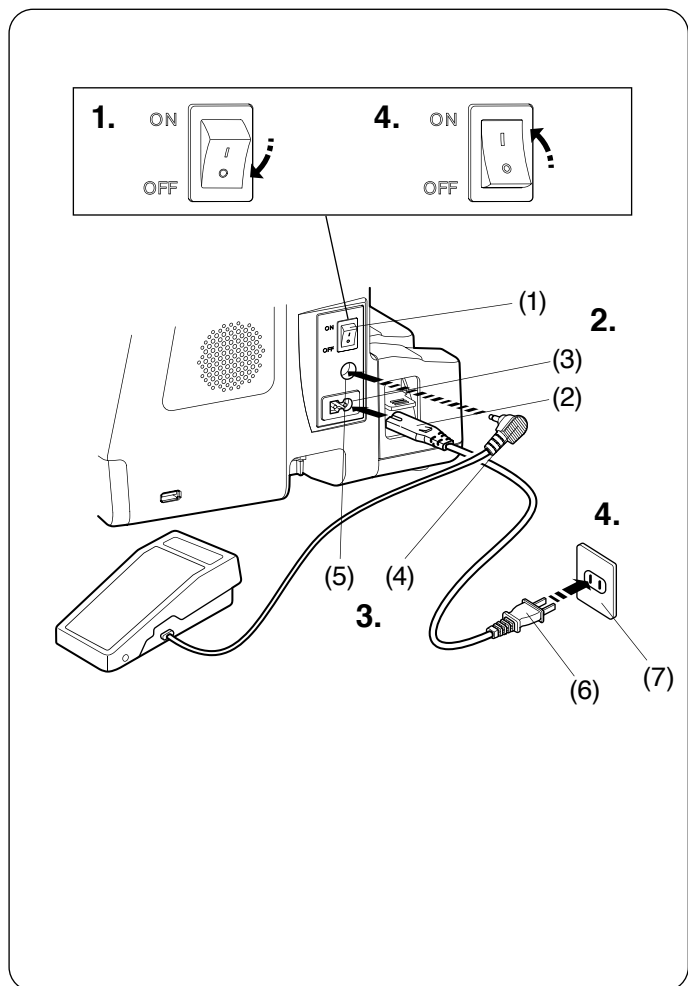

Using foot control

If you wish to use the foot control, insert the pin connector into the jack on the machine.

1. First make sure the power switch is OFF.
2. Insert the machine plug of the power supply cable into the machine socket.
3. Insert the pin connector into the foot control jack on the machine.
4. Insert the power supply plug into the wall outlet, and turn the power switch ON.

- (1) Power switch
- (2) Machine plug
- (3) Machine socket
- (4) Pin connector
- (5) Foot control jack
- (6) Power supply plug
- (7) Wall outlet

NOTE:

- The start/stop button does not work when the foot control is connected except variable zigzag sewing.
- Connect the foot control when sewing the variable zigzag sewing (refer to page 63).

Operating Instructions:

Foot control model YC-485EC-1 (YDK) is for use with this sewing machine.

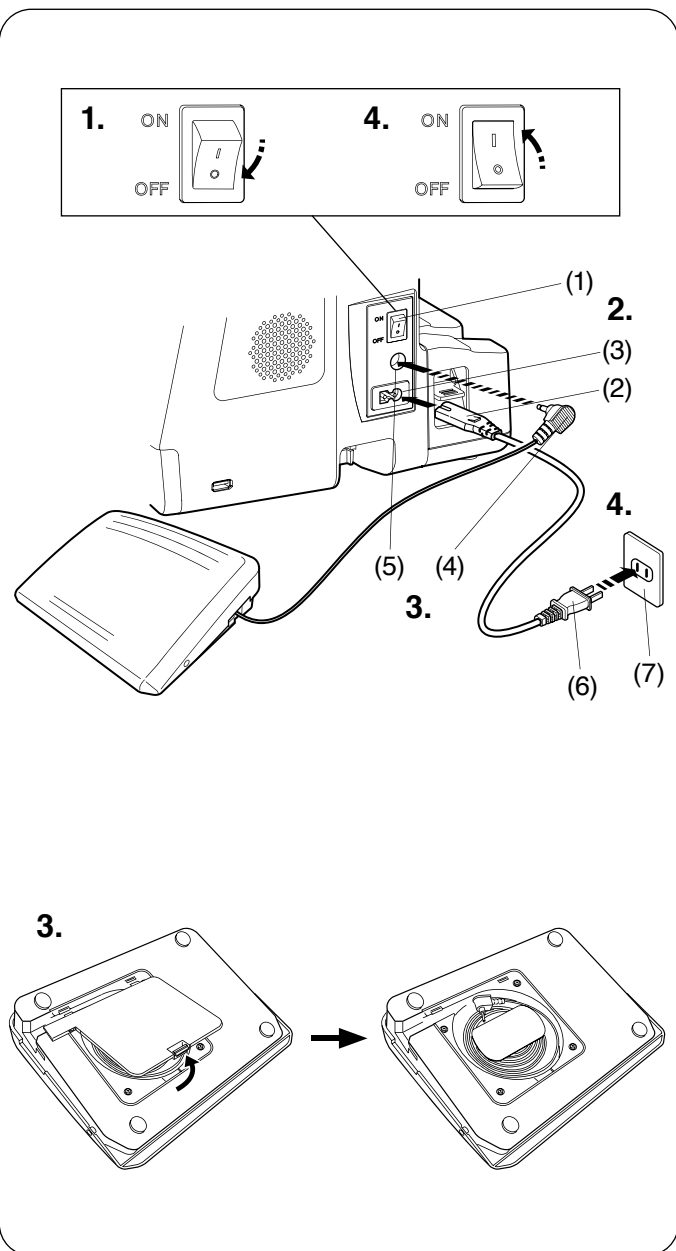

Using optional foot control

If you wish to use the optional foot control, pull out the cord from the foot control and insert the pin connector into the foot control jack on the machine.

1. First make sure the power switch is OFF.
2. Insert the machine plug of the power supply cable into the machine socket.
3. Pull out the cord from the foot control and insert the pin connector into the foot control jack on the machine.
4. Insert the power supply plug into the wall outlet, and turn the power switch ON.
 - (1) Power switch
 - (2) Machine plug
 - (3) Machine socket
 - (4) Pin connector
 - (5) Foot control jack
 - (6) Power supply plug
 - (7) Wall outlet

NOTE:

- The start/stop button does not work when the foot control is connected except variable zigzag sewing.
- Connect the foot control when sewing the variable zigzag sewing (refer to page 63).

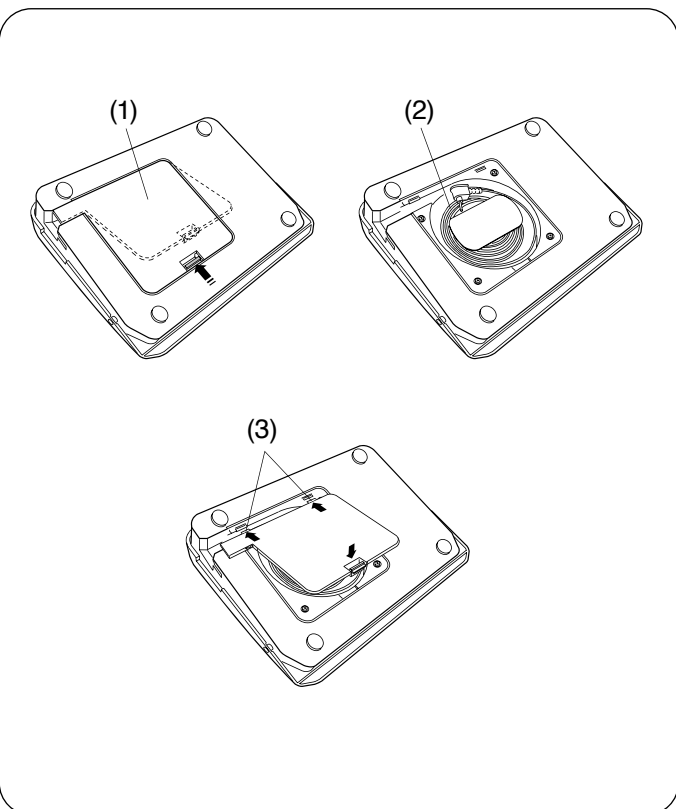

Cord storage

The cord of the foot control can be conveniently stored in the cord storage under the base cover of the foot control.

- (1) Base cover
- (2) Cord
- (3) Hooks

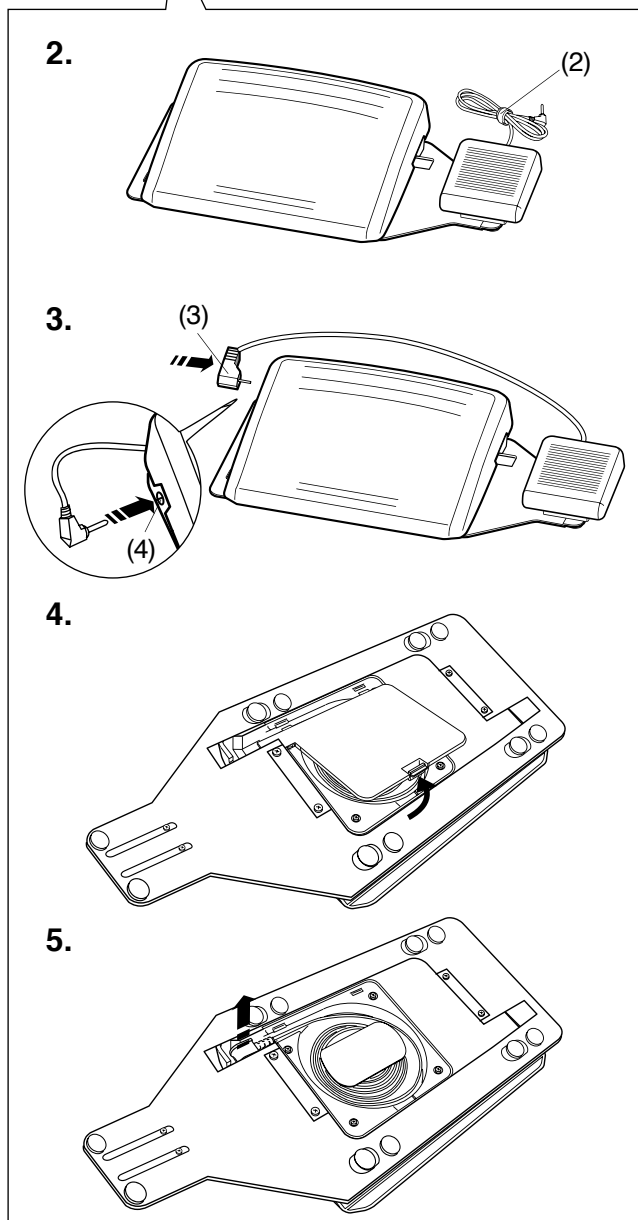
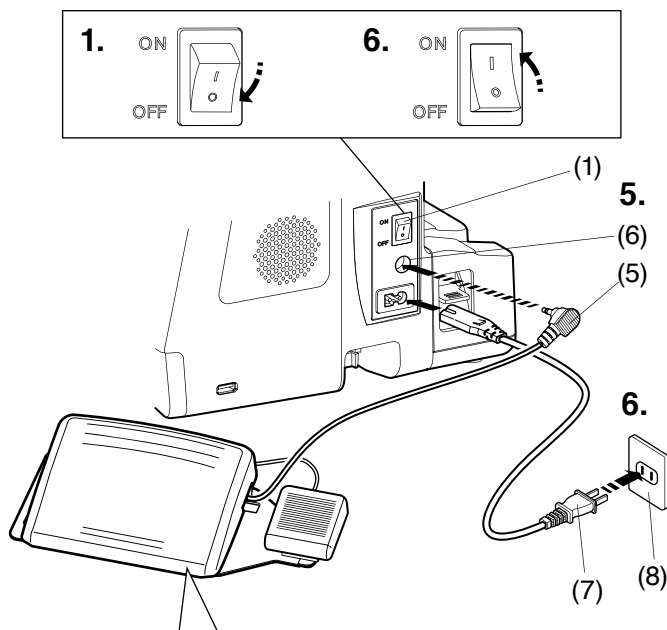

Using optional thread cutter switch

If you wish to use the optional thread cutter switch, insert the pin connector of the thread cutter switch into the jack on the foot control (optional), and insert the pin connector of the foot control into the foot control jack on the machine.

1. First make sure the power switch is OFF.
2. Remove the cable tie from the cable.
3. Insert the pin connector (thread cutter switch) into the jack on the foot control.
4. Flip the foot control upside down and open the cover.
5. Draw the cord from the foot control and insert the pin connector (foot control) into the foot control jack on the machine.
6. Insert the power supply plug into the wall outlet, and turn the power switch ON.

- (1) Power switch
- (2) Cable tie
- (3) Pin connector (thread cutter switch)
- (4) Jack on the foot control
- (5) Pin connector (foot control)
- (6) Foot control jack
- (7) Machine plug
- (8) Wall outlet

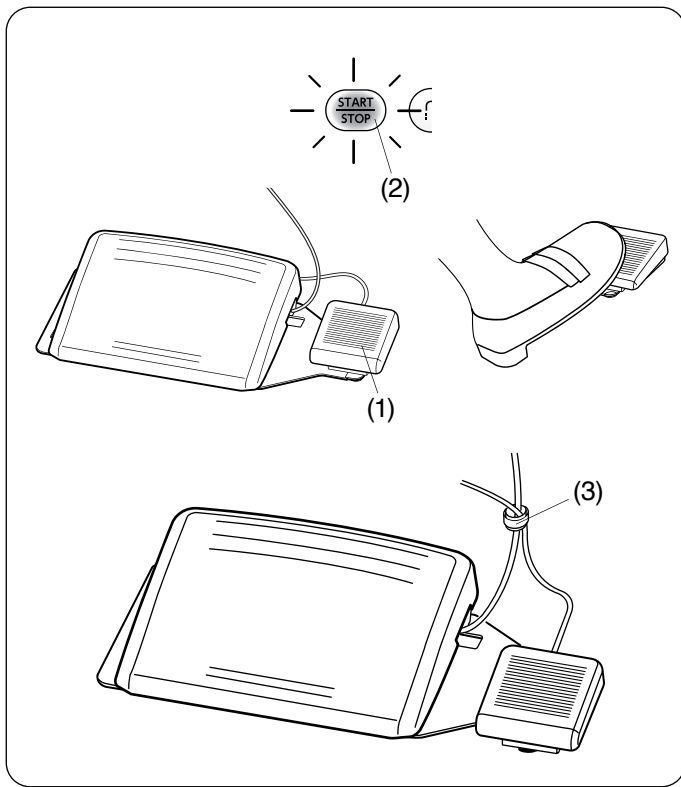

After sewing, depress the thread cutter switch on the right side of the foot control to trim both the needle and bobbin threads.

Do not depress the thread cutter switch until the start/stop button turns blue.

- (1) Thread cutter switch
- (2) Start/stop button

NOTE:

- Threads are trimmed when the thread cutter switch is depressed for more than 0.5 seconds.
- The thread cutter switch does not work without the foot control being depressed first.
- Bundle the cables with the cable tie as necessary.

- (3) Cable tie

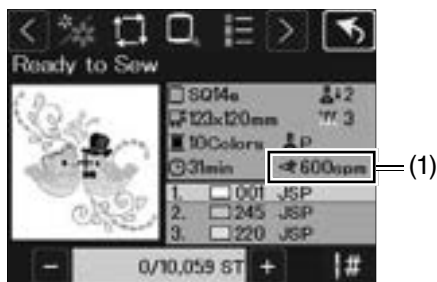
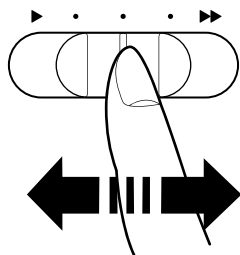

Controlling sewing speed

Speed control slider

You can limit the maximum sewing speed with the speed control slider according to your sewing needs.

To increase the sewing speed, move the slider to the right.

To decrease the sewing speed, move the slider to the left.

The sewing speed can be changed while stitching.

Maximum sewing speed in the embroidery mode is displayed on the Ready to Sew window.

(1) Maximum sewing speed

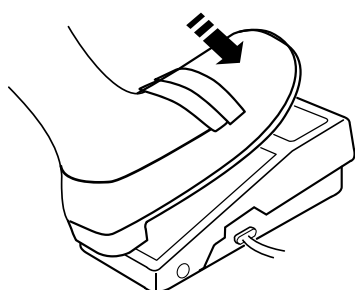

Foot Control

Pressing on the foot control can vary sewing speed.

The harder you press the foot control, the faster the machine runs.

For variable zigzag sewing, refer to page 63.

NOTE:

- The machine runs at the maximum speed set by the speed control slider when the foot control is fully depressed.
- You can select the desired start-up speed from 1 to 5 by pressing the corresponding key (refer to page 171).
- This machine is equipped with an automatic shutdown safety feature to prevent overheating whenever the machine is running overloaded. Follow the safety instructions that appear on the visual touch screen (refer to page 186).

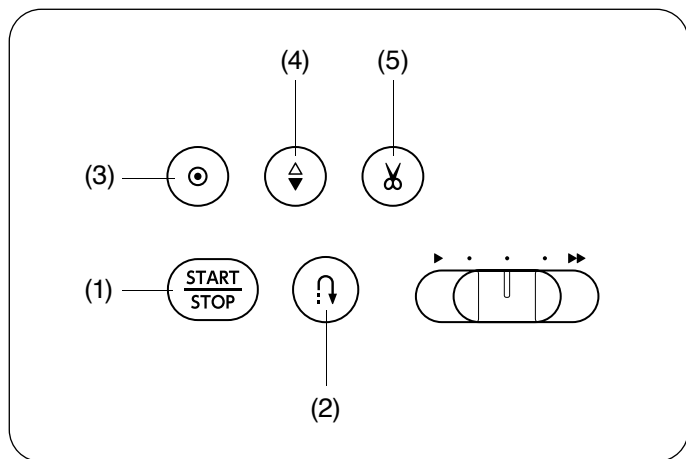

Machine Operating Buttons

(1) Start/stop button

Press this button to start or stop the machine. The machine starts running slowly for the first few stitches, then runs at the speed set by the speed control slider. The machine runs slowly as long as this button is pressed. The button will turn red when the machine is running, and blue when it has been stopped. Pressing and holding this button while sewing will slow down the sewing speed and the machine will stop when the button is released.

NOTE:

- The start/stop button cannot be used when the foot control is connected to the machine.
- You can select the desired start-up speed from 1 to 5 by pressing the corresponding key (refer to page 171).

(2) Reverse button

- When the following stitch patterns are selected:

Utility	Quilt	Bridge

The machine will sew in reverse as long as the reverse button is pressed. Release the button to sew forward. When the machine is stopped and foot control is disconnected, the machine will sew in reverse slowly as long as the reverse button is pressed. Release the button to stop the machine.

- When any other stitches are selected:

If you press the reverse button when sewing any other patterns, the machine will immediately sew locking stitches and automatically stop. When the reverse button is pressed while the machine is stopped, the machine will immediately sew locking stitches and automatically stop after the machine is started.

NOTE:

There will be particular functions of the reverse button when stitch pattern U2, U3, B13 or B14 is selected. Refer to pages 46-47, 76 and 78 for instructions.

(3) Auto-lock button

- When the following stitch patterns are selected:

Utility	Quilt	Bridge

Press the auto-lock button to sew a locking stitch immediately. The machine will automatically stop. When the auto-lock button is pressed while the machine is stopped, the machine will immediately sew locking stitches and automatically stop after the machine is started.

- When any other stitches are selected:

Press the auto-lock button to sew a locking stitch at the end of current pattern. The machine will automatically stop. When the machine is stopped, press the auto-lock button to sew a locking stitch at the end of current pattern and the machine will automatically stop after the machine is started. The machine will trim the threads automatically after locking the stitch when the auto thread cutting is turned on (refer to page 170).

(4) Needle up/down button

Press this button to bring the needle bar up or down. The machine will stop with the needle in down position. However, you can change the needle stop position in the machine setting mode (refer to page 170).

(5) Thread cutter button

After finishing sewing, press this button to trim the threads. The needle bar automatically rises after trimming the threads (refer to page 43).

After using auto thread cutting or threading the bobbin holder, you can start sewing without drawing up the bobbin thread.

NOTE:

- The thread cutter button does not function:
 - directly after turning ON the power.
 - when the presser foot is raised with the presser foot lifter.
 - after being pressed 3 times in a row.
- Use the thread cutter on the face cover if the thread is #30 or thicker (refer to page 43).

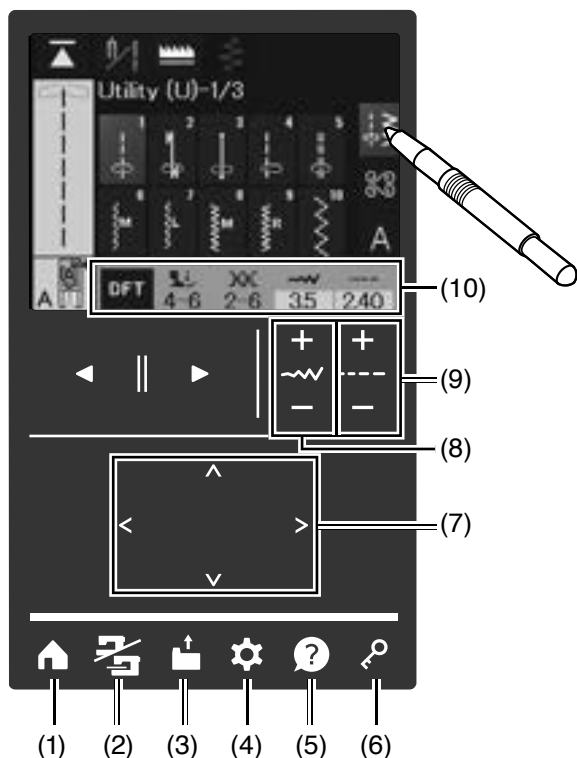

Touch Screen Keys



CAUTION:

Do not press the visual touch screen with hard or sharp objects like pencils or screwdrivers. Use touch screen stylus included in the standard accessories.

(1) Home key (refer to page 117)

Press this key to go to the top of the category selections for the ordinary sewing mode or the embroidery mode window.

(2) Mode switch key

Press this key to switch the ordinary sewing mode or embroidery mode.

(3) Open file key (refer to pages 162-165)

Press this key and the open file window will open.

You can open pattern combinations and monograms saved in the machine's internal memory or on a USB flash drive.

(4) Set mode key (refer to pages 166-178)

Press this key to enter the setting mode. You can customize the machine settings to your preference.

The settings for "Machine Settings", "Ordinary Sewing Settings", "Embroidery Settings", and "Language Setting" are available in this mode.

(5) Help key (refer to page 18)

Press this key and the help window will open.

(6) Lockout key

Press this key to lockout the machine when threading the machine, replacing the accessories, etc.

To reduce the risk of injury, all the buttons and keys except the lockout key are deactivated.

To unlock the machine, press this key again.

(7) Cursor keys

Press the cursor keys to move the cursor, the embroidery hoop or designs in editing window, etc.

(8) Stitch width adjustment keys (refer to pages 40, 55, 64, 70, 85, 99, etc.)

Press the "+" or "-" key to alter the stitch width or needle drop position of the selected pattern.

(9) Stitch length adjustment keys (refer to pages 41, 64, 70, 77, 79, 99, etc.)

Press the "+" or "-" key to alter the stitch length of the selected stitch pattern.

(10) Manual stitch setting window (refer to pages 40-41)

Recommended presser foot pressure value and needle thread tension are displayed on the window.

The stitch width and stitch length or needle drop position of the selected pattern are also displayed. You can alter those settings with the stitch length/width adjustment key. Press the default key to recover the original stitch setting.

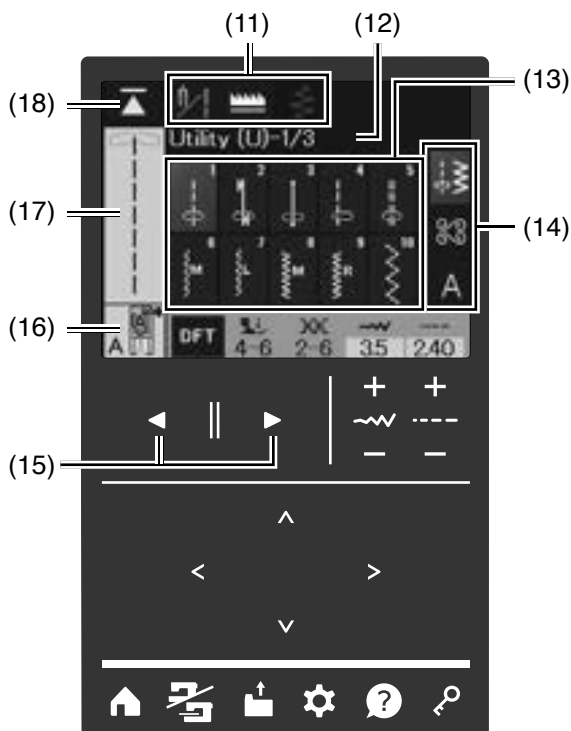

(11) Function key (refer to pages 38-39)

You can change sewing settings for the selected pattern to suit your personal preference.

(12) Stitch category name and page

You can see the stitch category name and pages.

(13) Pattern selection keys

Press this key to sew the desired pattern directly.

(14) Category selection keys (refer to pages 36-37)

Press these keys to select the desired stitch category.

(15) Page keys (refer to pages 120, 143)

Press the page keys to display the next page or previous page. In embroidery mode, you can switch embroidery patterns or layers.

(16) Presser foot

The presser foot suitable for typical sewing of the selected pattern is displayed.

The presser foot varies depending on the purpose of sewing.

(17) Preview

The images of selected stitch patterns are shown in the edit box.

(18) Startover key (refer to page 100)

If you stop sewing in the middle of a stitch pattern and wish to sew the pattern again from the beginning, press this key before you start sewing.

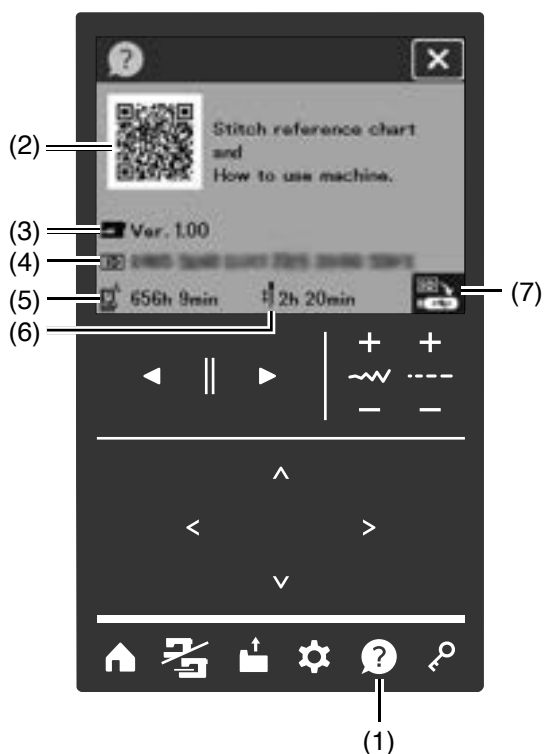

Help Screen

Press the help key to show the help window. You can check the QR code, software version of the machine, machine ID, total power-on time of the machine, and total operating time of the machine.

- (1) Help key
- (2) QR code
- (3) Software version
- (4) Machine ID
- (5) Total power-on time
- (6) Total operating time

Read the QR code to see the instructional video, stitch chart (ordinary), design chart (embroidery) and quick reference chart.

Press the machine ID copy key to save the machine ID (machineID.txt) to the USB flash drive inserted in the sewing machine.

- (7) Machine ID copy key

NOTE:

- QR code reader (scanner) application can be downloaded from App store or market. Standard data charges from your internet provider may apply.
- QR Code is a registered trademark of Denso Wave Inc.

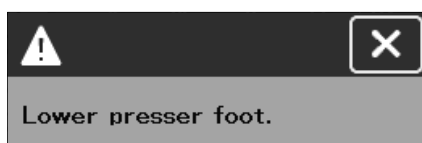
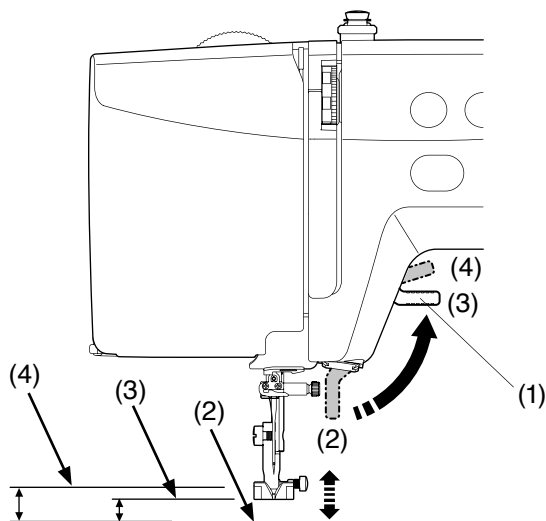

Raising and Lowering the Presser Foot

⚠ CAUTION:

Do not turn the handwheel or press the needle up/down button when the presser foot is in extra lifted position. This may cause damage to the presser foot.

The presser foot lifter raises and lowers the presser foot. You can raise the presser foot about 6 mm (1/4") higher than the normal up position by exerting more pressure when lifting the presser foot lifter. This helps you to place layers of thick fabric.

- (1) Presser foot lifter
- (2) Down position
- (3) Up position
- (4) Extra lifted position

NOTE:

If you press the start/stop button without lowering the presser foot, the warning message appears on the visual touch screen. Lower the presser foot lifter and press the start/stop button.

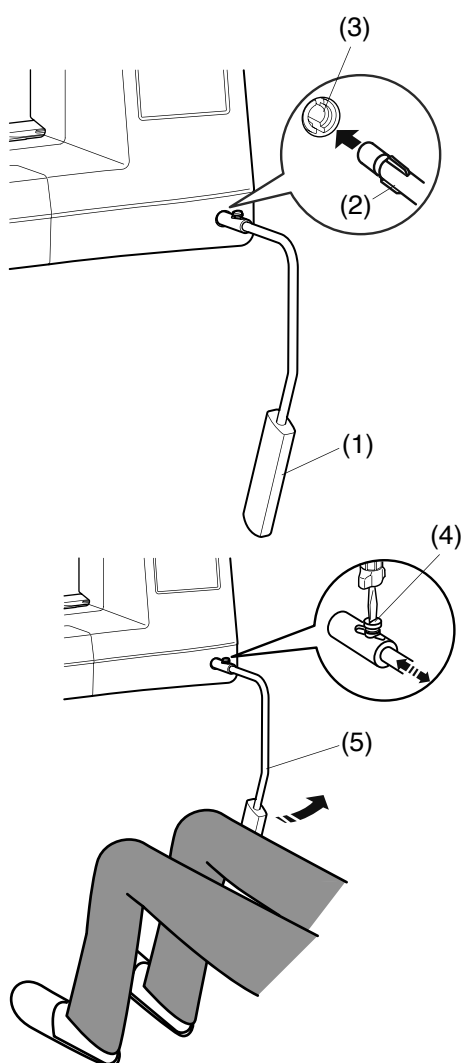

Knee Lifter (optional)

The knee lifter is extremely helpful when sewing patchwork, quilting, etc. since it allows you to handle the fabric while your knee controls the presser foot.

Attaching the knee lifter

Match the ribs on the knee lifter with the notches in the knee lifter socket and insert the knee lifter.

- (1) Knee lifter
- (2) Rib
- (3) Knee lifter socket

Adjusting the knee lifter

The angle of the knee lifter can be adjusted to fit the user. Loosen the setscrew and slide the angle bar in or out to adjust the angle of the knee lifter.

Tighten the setscrew to secure the angle bar.

- (4) Setscrew
- (5) Angle bar

Using the knee lifter

Push the knee lifter with your knee to easily move the presser foot up and down.

You can control how high the foot rises by the amount of knee pressure you exert.

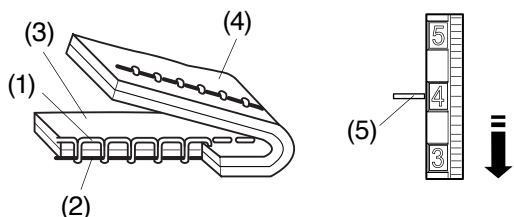
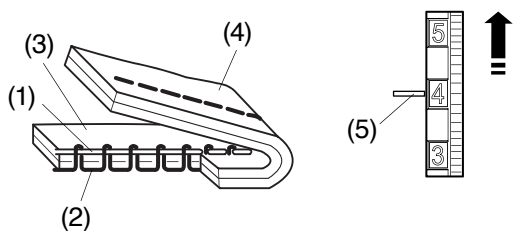
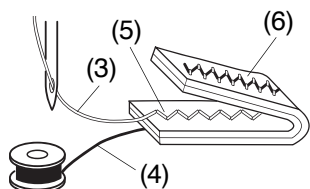
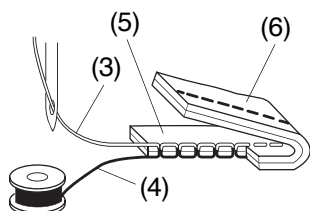
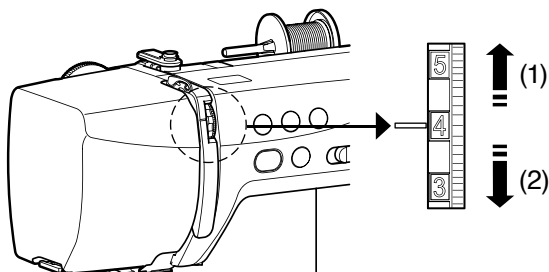

Adjusting Thread Tension

Select the stitch pattern to show the optimized thread tension.

NOTE:

- You may need to manually adjust the tension balance depending on the sewing conditions, or you can fine-tune the thread tension to suit your preference.
- Set the thread tension dial at “3” in the embroidery mode (refer to page 110).

Adjust the thread tension dial to the number shown on screen.

- Turn the dial to smaller number, and the needle thread tension becomes weaker.
- Turn the dial to bigger number, and the needle thread tension becomes stronger.

Balanced thread tension

Straight stitch: Both needle and bobbin threads interlock between the layers.

Zigzag stitch: The needle thread appears slightly on the wrong side of the fabric.

- Needle thread
- Bobbin thread
- Right side of the fabric
- Wrong side of the fabric

Needle thread tension is too tight:

Turn the dial to smaller number.

Needle thread tension is too weak:

Turn the dial to bigger number.

- Needle thread
- Bobbin thread
- Right side of the fabric
- Wrong side of the fabric
- Setting mark

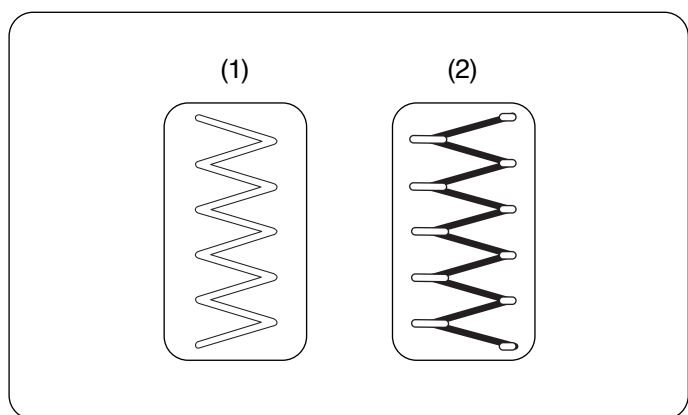

Correct tension

- (1) Right side (top side) of fabric
- (2) Wrong side (bottom side) of fabric

Minimize the amount of needle thread visible on the wrong side (bottom side) of the fabric without causing excessive puckering, or causing the bobbin thread to show on the right side (top side) of the fabric.

Results vary with fabric, thread and sewing conditions.

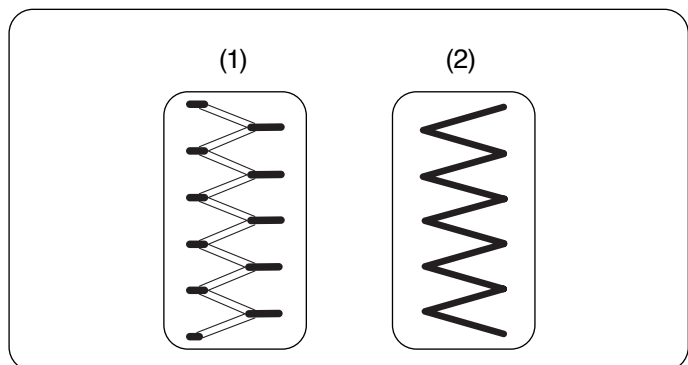

Tension is too tight

The corner of each zigzag point pulls together on the right side of the fabric.

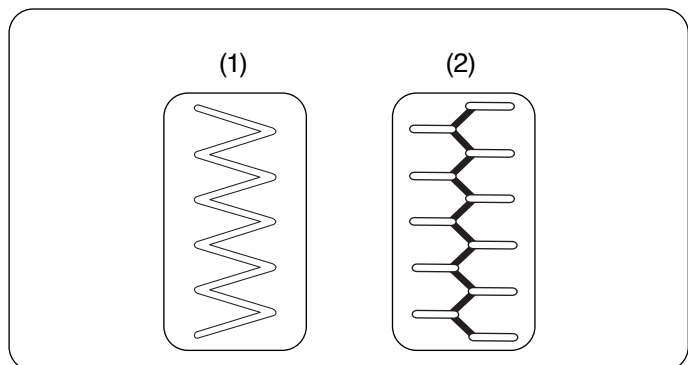

Tension is too loose

The corner of each zigzag point pulls together on the wrong side of the fabric.

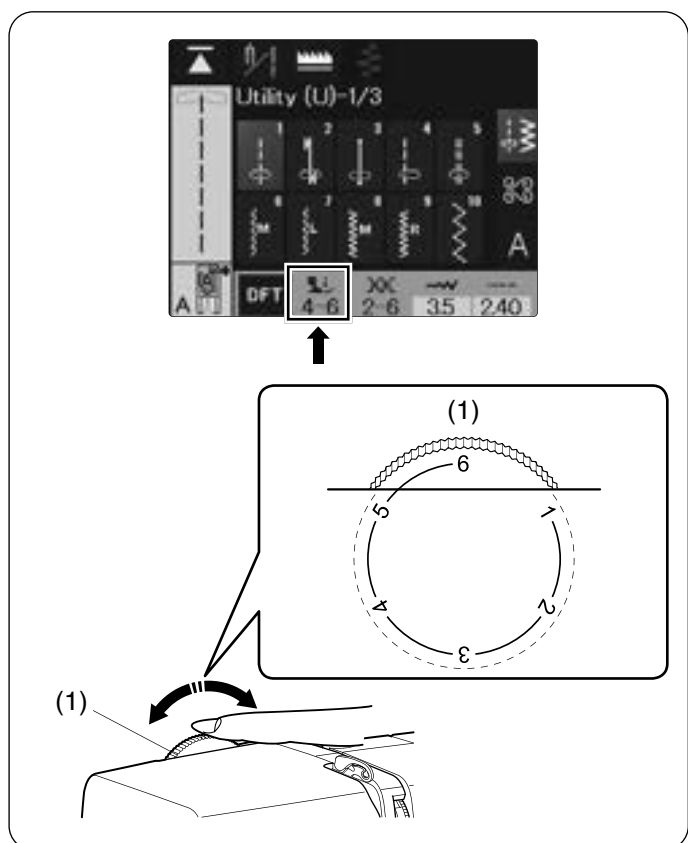

Adjusting Presser Foot Pressure

Select the stitch pattern to show the optimized presser foot pressure.

Adjust the presser foot pressure dial to the number shown on screen.

- (1) Presser foot pressure dial

NOTE:

- Turn the dial to smaller number, and the presser foot pressure becomes weaker.
- Set the presser foot pressure dial at "2" for embroidery (refer to page 110).

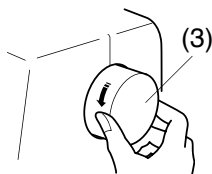
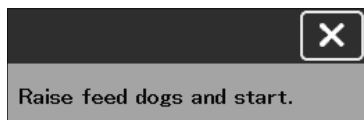
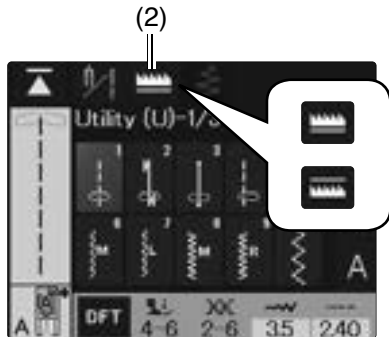
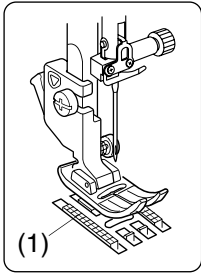

Dropping the Feed Dogs

The feed dogs can be lowered for sewing on buttons, free motion quilting, etc.

Press the drop feed key to lower the feed dogs. The feed dogs position is displayed as the drop feed key.

- (1) Feed dogs
- (2) Drop feed key

NOTE:

- If you start the machine with the feed dogs lowered, a message will appear on the visual touch screen.
- Retract the carriage arm before raising/lowering the feed dogs.
- The setting by drop feed key takes precedence over feed dogs setting in ordinary sewing settings (refer to page 172).

Press the drop feed key again after sewing with lowering the feed dogs.

Turn the handwheel toward you to make sure the feed dogs are raised.

- (3) Handwheel

1.

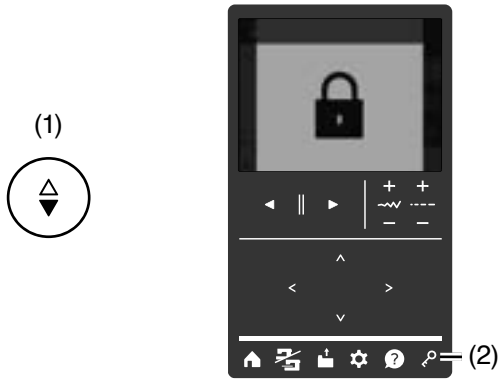

2.

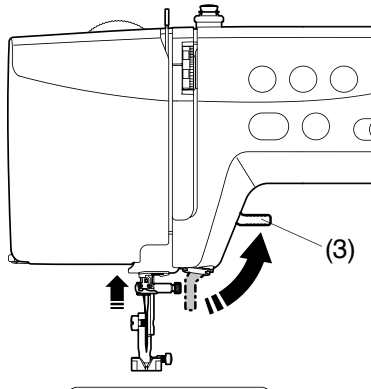

3.

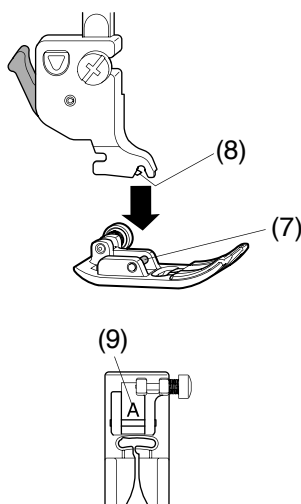
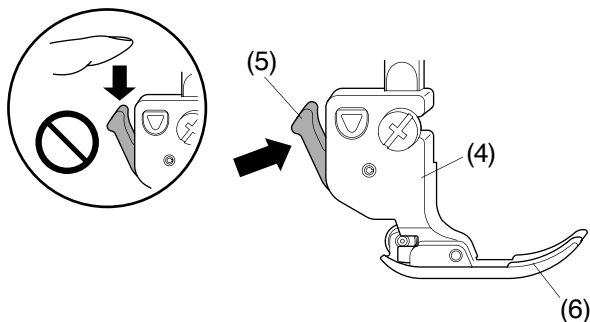

Replacing the Presser Foot

⚠ CAUTION:

- Always make sure to press the lockout key to lockout the machine or turn the power switch OFF before replacing the presser foot.
- Use the proper foot for the selected pattern. The wrong foot can cause the needle to break.

Removing the presser foot

1. Raise the needle by pressing the needle up/down button.

Press the lockout key to lockout the machine.

- (1) Needle up/down button
- (2) Lockout key

2. Raise the presser foot lifter.

- (3) Presser foot lifter

3. Press the black lever on the back of the foot holder.

The presser foot will drop off.

- (4) Foot holder
- (5) Lever
- (6) Presser foot

⚠ CAUTION:

To avoid damaging the lever, do not push it down.

Attaching the presser foot

Place the presser foot so that the pin on the foot lies just under the groove of the foot holder.

Lower the presser foot lifter to lock the foot in place.

- (7) Pin
- (8) Groove

Press the lockout key to lockout the machine.

NOTE:

Each foot is marked with an identification letter.

- (9) Identification letter

1.



2.

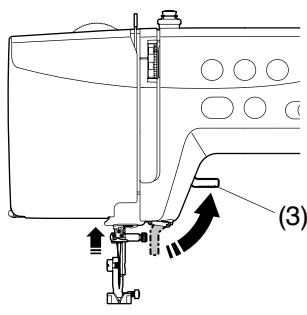

3.

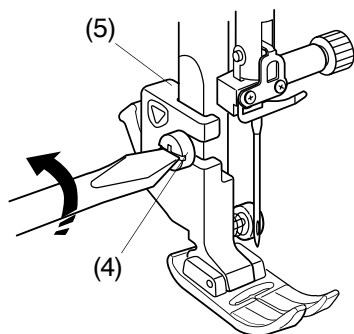

1. 3.

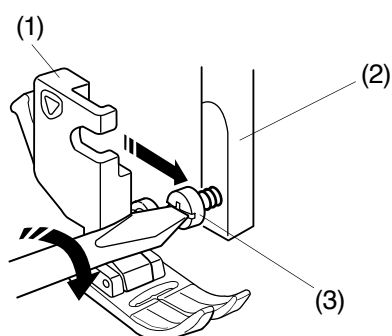

2.

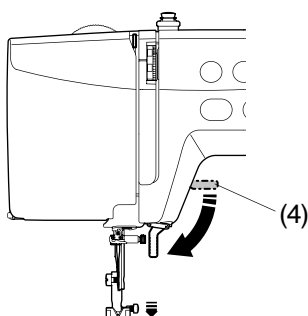

Removing and Attaching the Foot Holder

Remove the foot holder before using embroidery foot P.

⚠ CAUTION:

Always make sure to press the lockout key to lockout the machine or turn the power switch OFF before replacing the foot holder.

Removing the foot holder

1. Raise the needle by pressing the needle up/down button.

Press the lockout key to lockout the machine.

- (1) Needle up/down button
- (2) Lockout key

2. Raise the presser foot lifter.

- (3) Presser foot lifter

3. Loosen the setscrew and remove the foot holder.

- (4) Setscrew
- (5) Foot holder

Attaching the foot holder

1. Attach the foot holder to the presser bar from behind.

Tighten the setscrew partially with the screwdriver.

- (1) Foot holder
- (2) Presser bar
- (3) Setscrew

2. Lower the presser foot lifter.

- (4) Presser foot lifter

3. Tighten the setscrew securely with the screwdriver.

Press the lockout key to unlock the machine.

- (3) Setscrew

Replacing the Embroidery foot P



CAUTION:

Always make sure to press the lockout key to lockout the machine or turn the power switch OFF before replacing the presser foot.

Use embroidery foot P for embroidery.

Attach embroidery foot P to the presser bar from behind (refer to page 110).

Tighten the setscrew securely with the screwdriver.

(1) Setscrew

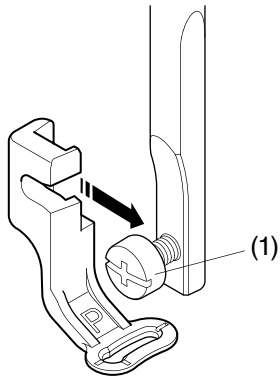

1.

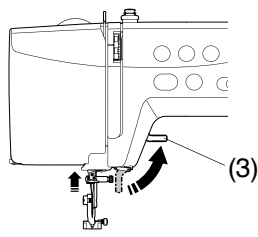
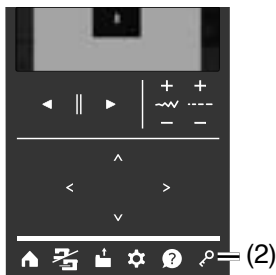
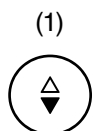

2.

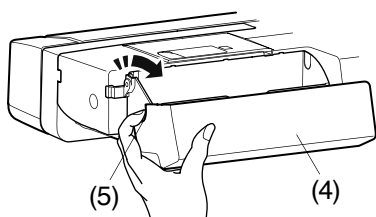

3.

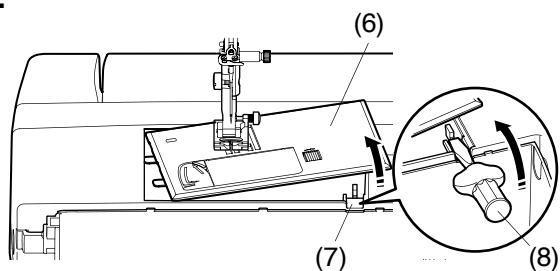

4.

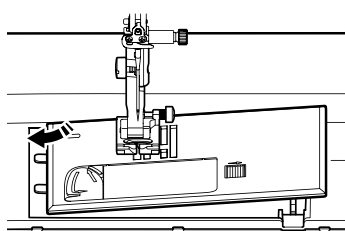

5.

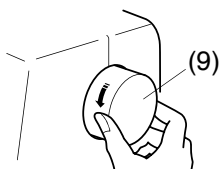

Replacing the Needle Plate

Use the straight stitch needle plate when embroidering.

CAUTION:

- Always make sure to press the lockout key to lockout the machine before replacing the needle plate.
- Never remove the needle plate while running the machine.

NOTE:

When the straight stitch needle plate is attached to the machine, the patterns not suitable for the straight stitch needle plate is grayed out and cannot be selected.

1. Press the needle up/down button to raise the needle. Press the lockout key to lockout the machine. Raise the presser foot lifter.
 - (1) Needle up/down button
 - (2) Lockout key
 - (3) Presser foot lifter
2. Hook your fingers in the hollow on the left side of the extension table. Push up the cover toward you to open it.
 - (4) Extension table
 - (5) Hollow
3. Insert the screwdriver into the needle plate release hole under the needle plate. Pull up the screwdriver as shown and remove the needle plate to the right.
 - (6) Needle plate
 - (7) Needle plate release hole
 - (8) Screwdriver
4. A warning message will appear that the needle plate is not secured. Place the needle plate on the machine. Set the left edge of the needle plate into the opening.
5. A message will appear when the needle plate is attached. Be sure the proper foot is attached to the machine. Turn the handwheel slowly and make sure that the needle does not hit the needle plate. Press the X key. Press the lockout key to unlock the machine.
 - (9) Handwheel
 - (10) X key

1.

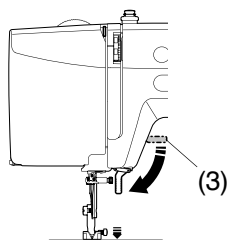

2.

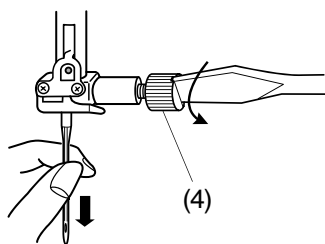

3.

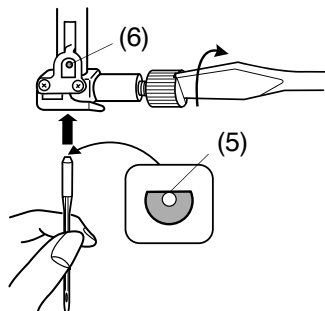

(7)

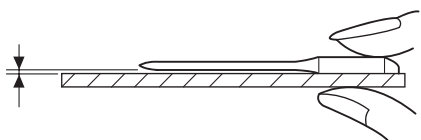

Replacing the Needle



CAUTION:

Always make sure to press the lockout key to lockout the machine or turn the power switch OFF before replacing the needle.

1. Raise the needle by pressing the needle up/down button.

Press the lockout key to lockout the machine.

Lower the presser foot lifter.

- (1) Needle up/down button
- (2) Lockout key
- (3) Presser foot lifter

2. Loosen the needle clamp screw by turning it counterclockwise.

Remove the needle from the clamp.

- (4) Needle clamp screw

3. Insert a new needle into the needle clamp with the flat side of the needle to the rear.

When inserting the needle into the needle clamp, push it up against the stopper pin and tighten the needle clamp screw firmly with a screwdriver.

Press the lockout key to unlock the machine.

- (5) Flat side
- (6) Stopper pin



CAUTION:

Be sure to tighten the needle clamp screw firmly with a screwdriver when attaching a needle to the machine, otherwise the needle may break or cause malfunction.

To check needle straightness, place the flat side of the needle onto something flat (a needle plate, glass, etc.). The gap between the needle and the flat surface should be consistent.

- (7) Gap

Never use a blunt needle.

Fabric		Thread	Needle
Fine	Lawn Georgette Tricot Organza Crepe	Cotton #80-100 Synthetic #80-100	Blue tip needle Universal needle #9/65-11/75
Medium	Sheeting Jersey Broadcloth Fleece	Cotton #50-80 Synthetic #50-80	Blue tip needle Universal needle #11/75-14/90
Heavy weight	Denim Tweed Coating Quilting	Cotton #40-50 Synthetic #30-50	Universal needle #14/90-16/100

Fabric	Thread	Needle
Fine	Embroidery thread	Blue tip needle
Medium		Universal needle #11/75
Heavy weight		Universal needle #14/90

NOTE:

1 x twin needle, 1 x blue tip needle (#11/75), 2 x #11/75 needles and 1 x #14/90 needle are included in the needle case (Part No. 820827007).

Fabric and Needle Chart

For Ordinary sewing

- For general sewing, use needle size 11/75 or 14/90.
- A fine thread and needle should be used for sewing lightweight fabrics, so the fabric will not be marred.
- Heavy weight fabrics require a needle large enough to pierce the fabric without fraying the needle thread.
- Always test the needle size on a small scrap of the fabric that will be used for actual sewing.
- In general, use the same thread for the needle and bobbin.

For Embroidery

- When sewing stretch fabrics, very fine fabrics and synthetics, use a blue tip needle. The blue tip needle effectively prevents skipped stitches.
- For general embroidery, use a blue tip needle.
- Janome bobbin thread for embroidery is recommended for bobbin.

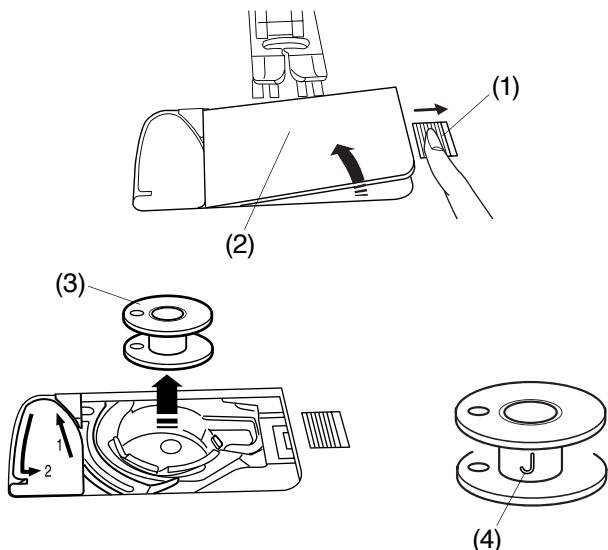

Winding the Bobbin

Removing the Bobbin

Raise the presser foot lifter.

Slide the hook cover release button to the right, and remove the hook cover plate.

Lift out the bobbin from the bobbin holder.

- (1) Hook cover release button
- (2) Hook cover plate
- (3) Bobbin

NOTE:

- Use “J” plastic bobbins (4) for the horizontal hook. Using other bobbins, such as pre-wound paper bobbins, may cause stitching problems and/or damage to the bobbin holder.
- Do not use the easy bobbin or metal bobbins.

Setting the spool of thread

Lift up the spool pin. Place the spool of thread on the spool pin.

Attach the spool holder (large), and press it firmly against the spool of thread.

- (1) Spool holder (large)

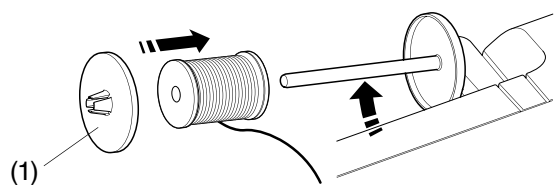

Use the spool holder (small) to hold narrow or small spools of thread.

- (2) Spool holder (small)

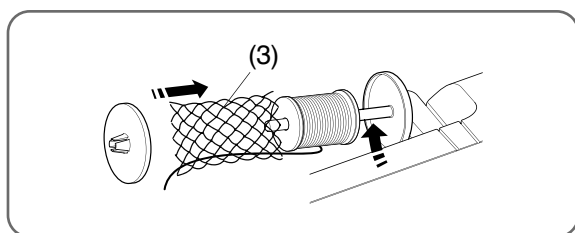
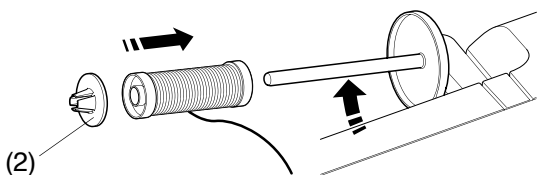

NOTE:

- If you use a slippery thread such as monofilament transparent thread, elastic thread or metallic thread, put a net on the spool of thread to prevent the thread from slipping off the spool and jamming around the spool pin.
- If the net is too long for the spool, fold the net and place it on the spool.
- A spool net is not included with this machine.
- (3) Spool net

Extra spool pin

Use the extra spool pin when you need to wind a bobbin without unthreading the machine while working on a sewing project (refer to page 30).

Insert the extra spool pin into the hole as shown.

Place a spool of thread on the extra spool pin and fix the spool with the spool holder.

- (1) Extra spool pin
- (2) Hole for extra spool pin
- (3) Spool holder (large)

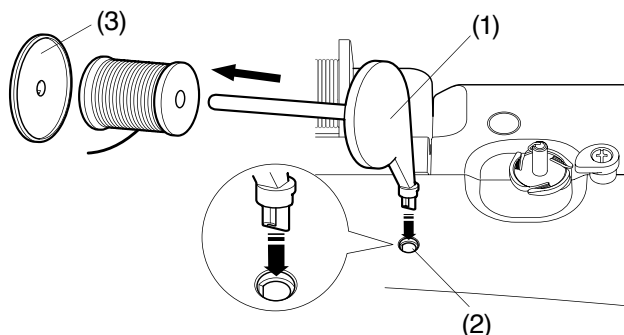

NOTE:

- The extra spool pin is also used for twin needle sewing (refer to page 106).
- Remove the extra spool pin when covering the machine with the soft cover.

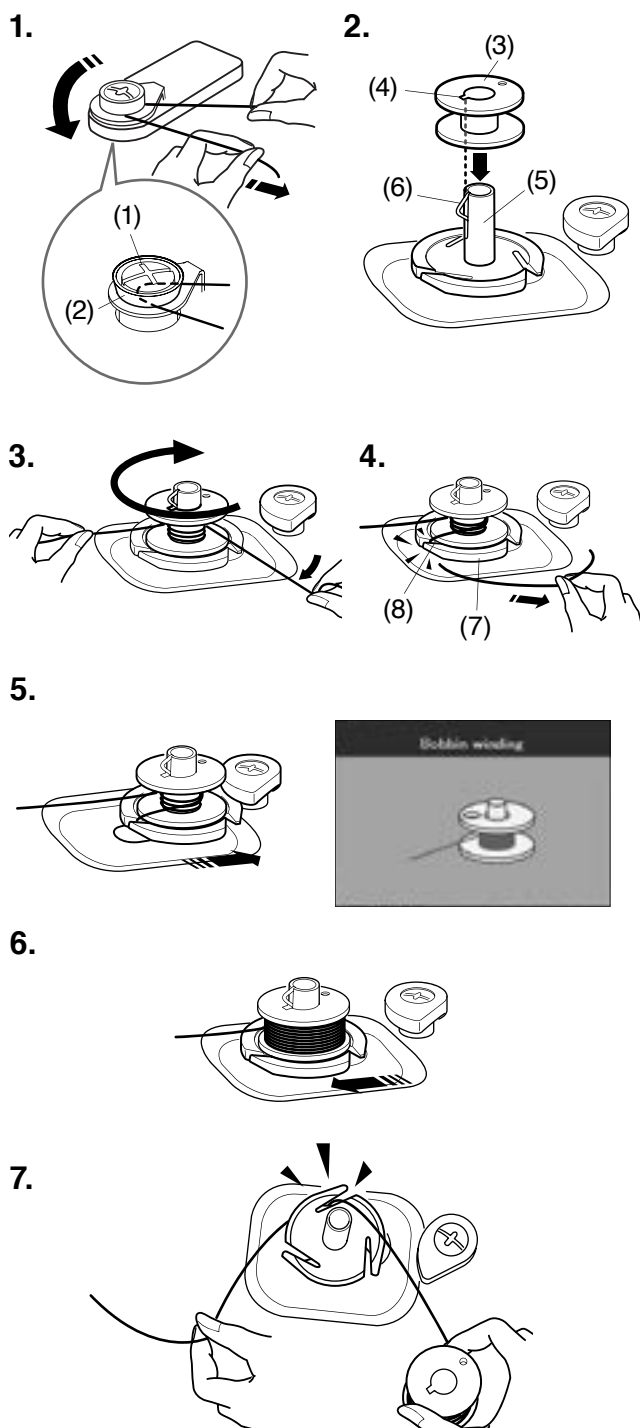
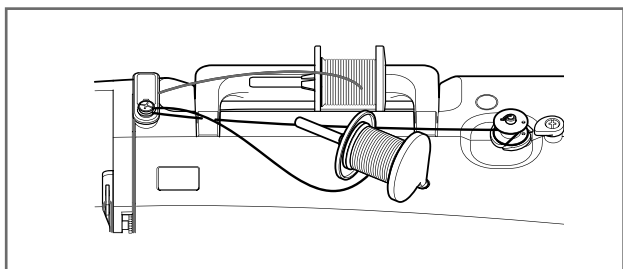
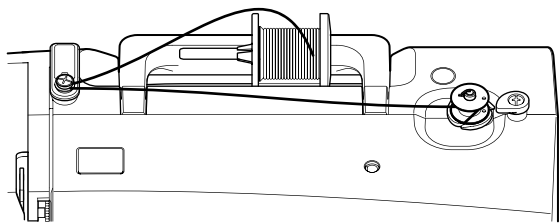

Winding the bobbin

NOTE:

Set the speed control slider at the fastest position (refer to page 15).

Bobbin winding when the extra spool pin is attached

If you want to wind the bobbin with the extra spool pin while sewing, draw the thread around the bobbin winding tension disk as shown.

(1) Bobbin winding tension disk

1. Pull the thread from the spool.
Hold the thread with both hands and pass the thread into the bobbin winding tension disk.
Draw the thread to the left and forward around the thread guide.
Firmly pull the thread to the right while holding it with both hands.
(1) Bobbin winding tension disk
(2) Disk
2. Put the bobbin on the bobbin winder spindle.
Be sure that the bobbin snaps into the place.
(3) Bobbin
(4) Slit
(5) Bobbin winder spindle
(6) Spring (Projection)
3. Pass the thread to the bobbin.
Hold the thread with both hands and wind it around the bobbin clockwise several times.
4. Insert the thread into one of the slits of the flange plate and pull the thread to cut.
(7) Flange plate
(8) Slit
5. Push the bobbin to the right. The visual touch screen will show the bobbin winding sign.

NOTE:

Do not move the bobbin winder spindle while the machine is running.

6. Start the machine.
Stop the machine when the bobbin is fully wound and stops spinning.
Return the bobbin winder spindle to its original position.
7. Remove the bobbin. Cut the thread with one of the slits of the flange plate.

NOTE:

For safety purposes, the machine will automatically stop 1.5 minutes after starting bobbin winding.

1.

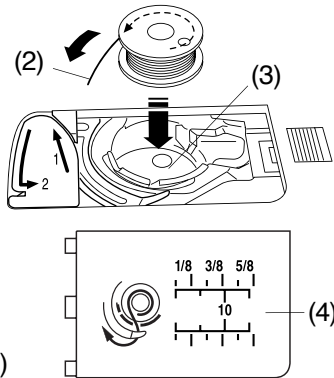
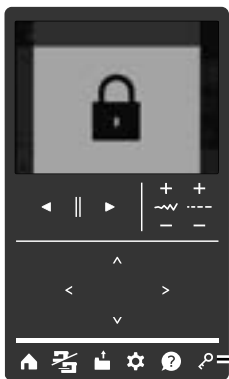

2.

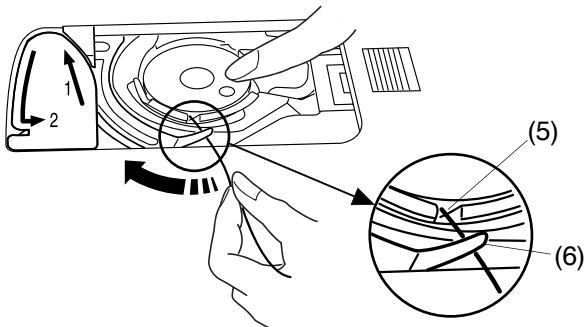

3.

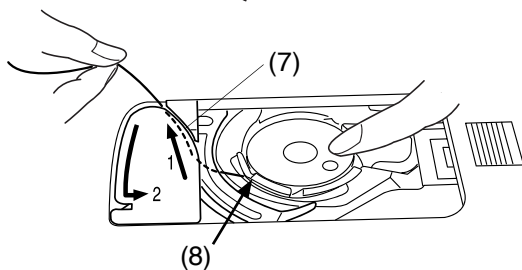

Correct

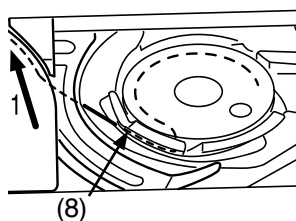

Wrong

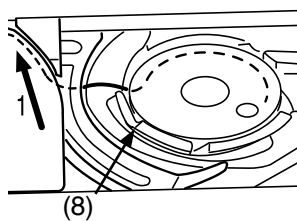

4.

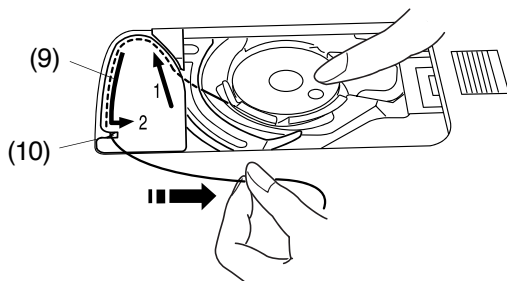

5.

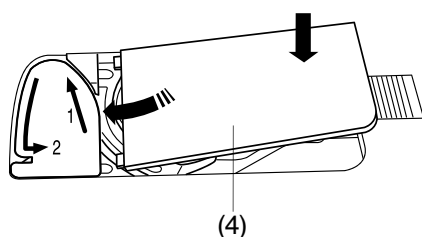

Inserting the Bobbin



CAUTION:

Always make sure to press the lockout key to lockout the machine or turn the power switch OFF before inserting the bobbin.

1. Press the lockout key to lockout the machine.

Place the bobbin in the bobbin holder with the thread running off counterclockwise as shown on the hook cover plate.

- (1) Lockout key
- (2) End of thread
- (3) Bobbin holder
- (4) Hook cover plate

2. Hold the bobbin with your fingertip so it does not rotate.

Guide the thread into the front notch of the bobbin holder.

Pull the thread to the left to pass it under the guide.

- (5) Front notch
- (6) Guide

3. Draw the thread to the left to pass it into the guide path marked "1".

Make sure that the thread comes out from the side notch of the bobbin holder.

- (7) Guide path 1
- (8) Side notch

NOTE:

If the thread does not come out from the side notch, rethread from step 1.

4. Continue to draw the thread along the guide path marked "2" and pull the thread to the right through the slit. The thread will be cut to a proper length and held in place.

- (9) Guide path 2
- (10) Slit (Thread cutter)

5. Set the left edge of the hook cover plate into the opening.

Push the hook cover plate down to fit in place.

- (4) Hook cover plate

NOTE:

- Unless otherwise noted, you can start sewing without drawing up the bobbin thread.
- Refer to page 35 for how to draw up the bobbin thread.

Threading the Machine

⚠ CAUTION:

Always make sure to press the lockout key to lockout the machine or turn the power switch OFF before threading the machine.

Raise the presser foot lifter.

Press the needle up/down button to raise the take-up lever to the highest position.

Press the lockout key to lockout the machine.

(1) Lockout key

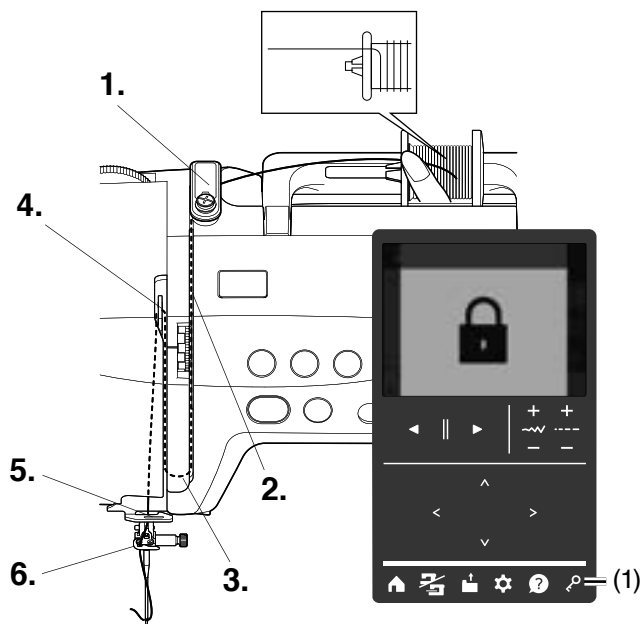

1. 2.

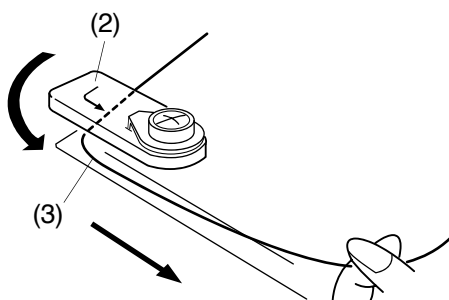

3.

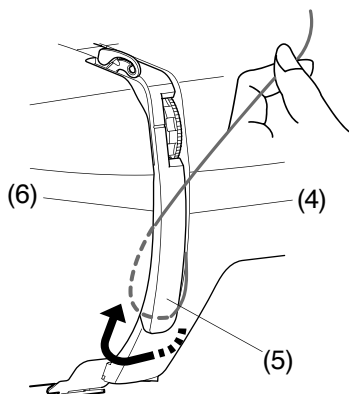

Pass the thread in order from 1. to 6.

1. Hold the thread with both hands and pass the thread into the upper thread guide.

(2) Upper thread guide

2. Be sure that the thread is pulled down under the notch and into the space below the thread guide plate as shown.

(3) Notch

3. Firmly pull the thread toward you along the right channel until the thread snaps.

Draw the thread down along the right channel and around the bottom of the thread guide plate. Pull the thread up along the left channel.

(4) Right channel

(5) Thread guide plate

(6) Left channel

4.

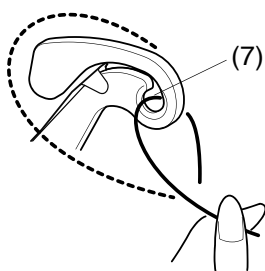

5. 6.

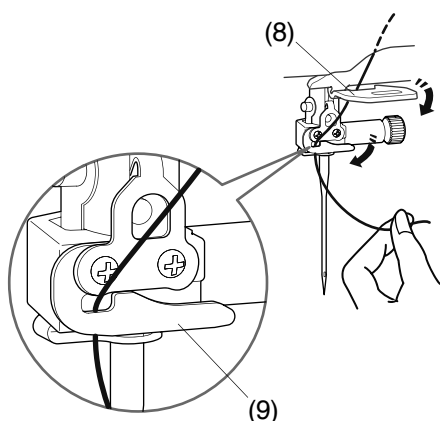

4. While holding the thread at the spool, firmly draw the thread up and to the back of the take-up lever. Draw the thread forward to slip it into the eye of the take-up lever.

(7) Eye of the take-up lever

5. Then pull the thread down along the left channel and through the lower thread guide.

(8) Lower thread guide

6. Slide the thread from the right of the needle bar thread guide to the left.

(9) Needle bar thread guide

Thread the needle with the needle threader (refer to page 34).

Example

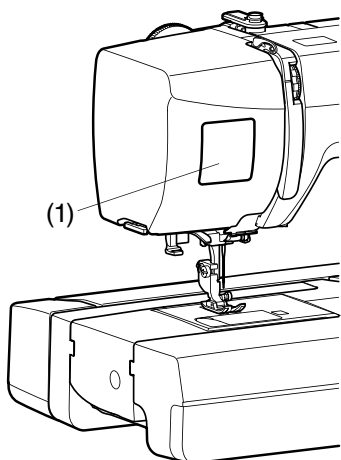

Guide sticker for threading

There is a threading guide sticker in the standard accessories. If you wish, you can attach the sticker on the machine to check the threading procedure.

- (1) Threading guide sticker

1.

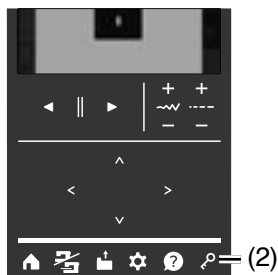

2.

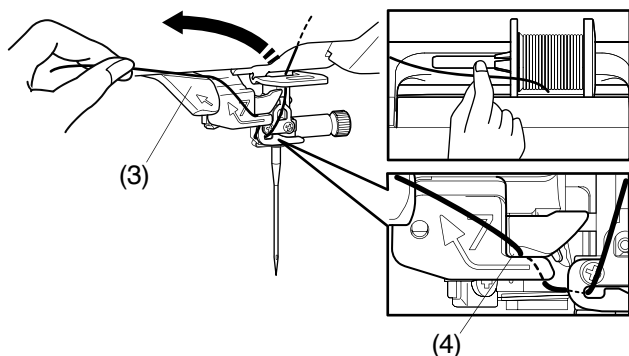

3.

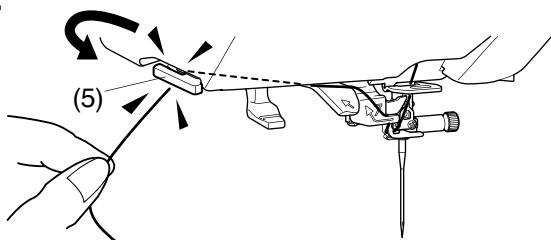

4.

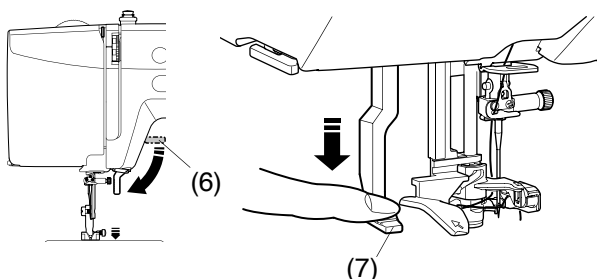

5.

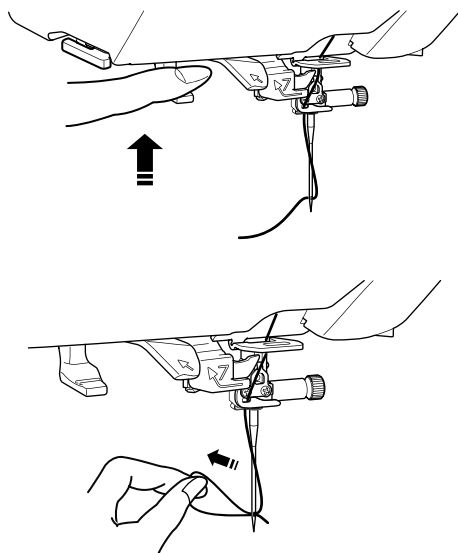

Built-in Needle Threader

⚠ CAUTION:

Always make sure to press the lockout key to lockout the machine or turn the power switch OFF before threading the machine.

NOTE:

- The needle threader can be used with a #11 to #16 needle.
- Thread size 50 to 90 is recommended.
- Do not use thread size 30 or thicker.
- The needle threader cannot be used with the twin needle.

1. Press the needle up/down button to raise the needle.
Press the lockout key to lockout the machine.
(1) Needle up/down button
(2) Lockout key
2. Pull the thread up to the left, over the needle threader guide while holding the thread near the spool with your hand.
(3) Needle threader guide

NOTE:

Be sure that the thread pass the slit of the needle threader as shown.

(4) Slit

3. Pull the thread up and slip it between the thread cutter and face cover from behind.
Pull the thread toward you to cut.
(5) Thread cutter
4. Lower the presser foot lifter.
Pull down the needle threader lever as far as it will go.
(6) Presser foot lifter
(7) Needle threader lever
5. Slowly release the needle threader lever to its original position to pass the thread through the needle eye.
Press the lockout key to unlock the machine.

NOTE:

If the thread loop is formed after releasing the needle threader lever, pull out the thread loop through the needle eye.

1.

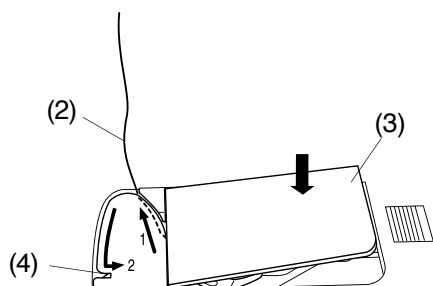
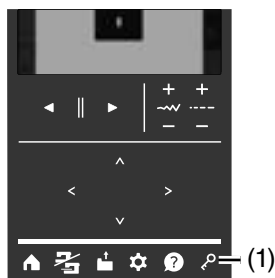

2.

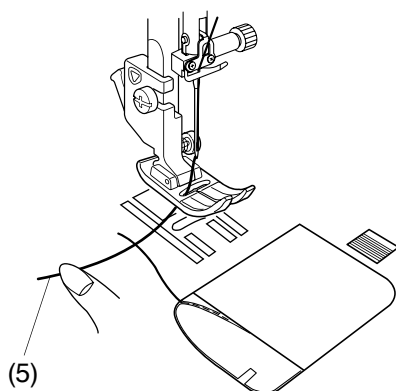

3.

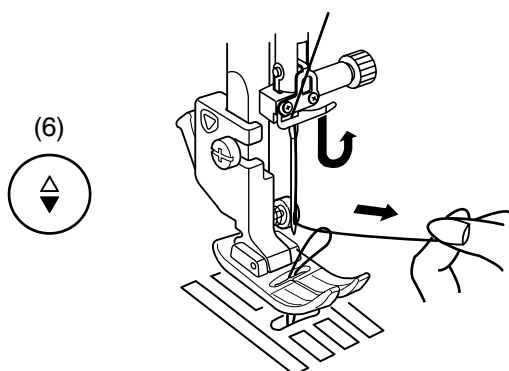

4.

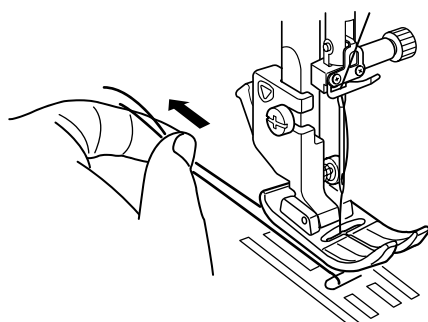

Drawing Up the Bobbin Thread

After using auto thread cutting or threading the bobbin holder, you can start sewing without drawing up the bobbin thread.

However, you need to draw up the bobbin thread when sewing gathering stitches, etc.

1. Press the lockout key to lockout the machine.
Turn the handwheel toward you to raise the needle.
Raise the presser foot lifter.
Remove the bobbin. Insert the bobbin into the bobbin holder again and rethread the bobbin holder according to the instructions on page 31, but leave a 10 cm (4") tail of bobbin thread as shown.

- (1) Lockout key
- (2) Bobbin thread
- (3) Hook cover plate

NOTE:

Do not cut the bobbin thread with the thread cutter.
(4) Thread cutter

2. Hold the needle thread lightly with your left hand.
(5) Needle thread

3. Press the needle up/down button twice to lower and raise the needle and pick up the bobbin thread.
(6) Needle up/down button

4. Pull both threads 10 cm (4") under and behind the presser foot.

Ordinary Stitch Patterns

- (1) Utility stitches, buttonholes and specialty stitches
- (2) Decorative and quilting stitches
- (3) Monogramming

Each category is composed of multiple pages.

- (4) Category selection keys
- (5) Page keys

In this manual, the pattern number refers to the initial letter for each group or category. For example, pattern #15 in the buttonholes and specialty stitches is referred to as pattern B15.



You can select utility stitches for seaming, overcasting, blind hemming and shell tucking.

There are various styles of buttonholes, darning, tacking and eyelet available in this category (refer to pages 65-79).

(2)



(2) Decorative and quilting stitches

This category consists of the following 11 groups (refer to pages 80-92).

1/3 Page

- Applique (A)
- Cross-Stitch (C)
- Heirloom (H)
- Quilt (Q)

2/3 Page

- Satin (S)
- Bridge (BR)
- Decorative (D)
- Botanical (BO)

3/3 Page

- Long (L)
- Life Style (LS)
- Kids (K)

(3)



(3) Monogramming

You can program lettering as well as a combination of characters and symbol patterns (refer to pages 102-105).

1/2 Page

- Block
- Script
- Broadway
- Cyrillic

2/2 Page

- Block (7 mm)
- Marumoji (7 mm)

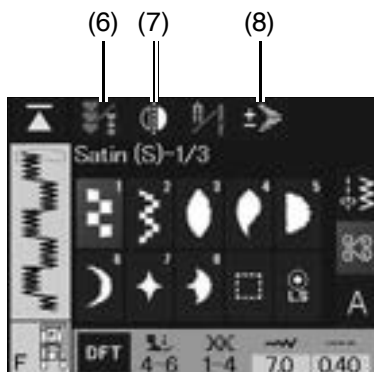
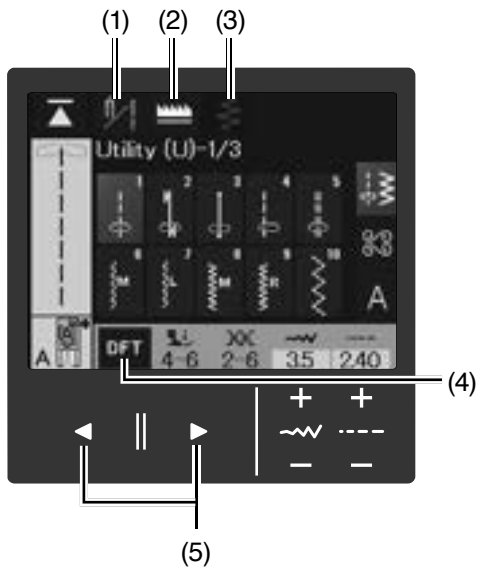

Utility Stitches

Function keys

Adjust the settings for the selected stitch pattern to your preference. Some function keys may be grayed out and cannot be selected depending on the selected stitch pattern.

(1) Twin needle key

Press this key to set the stitch width for twin needle sewing (refer to pages 106-107).

(2) Drop feed key

Press this key to drop or raise the feed dogs (refer to page 22).

(3) Variable zigzag key

Press this key for variable zigzag sewing (refer to page 63).

(4) Default key

Press this key to reset the settings (factory settings).

(5) Page keys

Press these keys to switch the pattern selection keys.

(6) Program key

Press this key to program a pattern combination. When this key is pressed, the mirror image key, preview key, delete key, letter size key, elongation key and the save file key will appear (refer to pages 93-101).

(7) Vertical mirror image key

Press this key to sew a vertical mirror image of the selected pattern (refer to pages 95-96).

(8) Elongation key

Press this key to elongate up to 5 times their original length while the stitch density remains the same (refer to page 91).

NOTE:

The elongation key (8) appears when a pattern from the Satin group is selected.

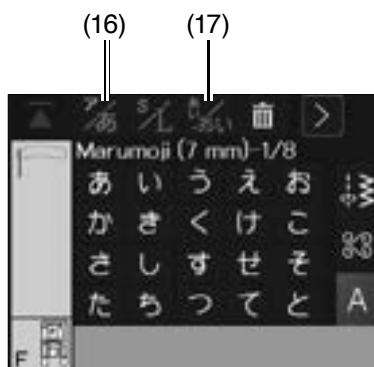
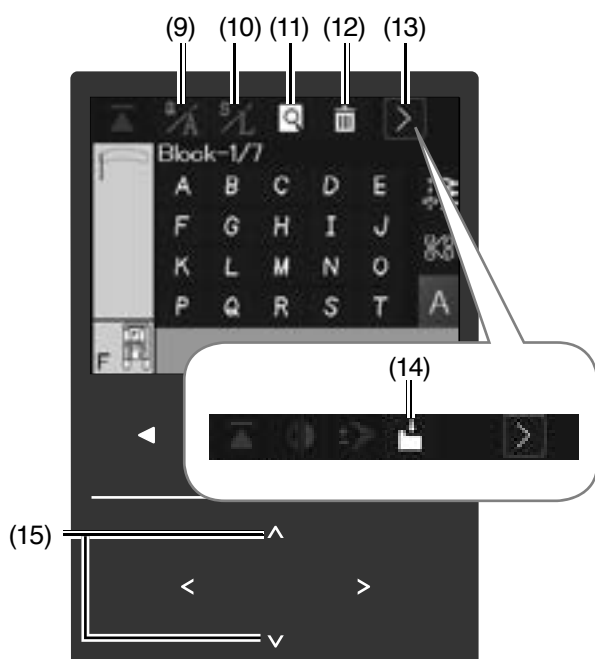

(9) Letter case key

Press this key to select upper case or lower case for monograms (refer to page 103).

(10) Letter size key

Press this key to select full size (L) or small size (S) (refer to page 105).

(11) Preview key

Press this key to view the stitch image of the entire pattern combination (refer to page 101).

(12) Delete key

Press this key to delete a pattern from the pattern combination (refer to page 98).

(13) Function switch key

Press this key to switch the function keys.

(14) Save file key

Press this key to save the pattern combination as a file (refer to pages 157-161).

(15) Cursor keys

Press one of these keys to move the cursor up or down (refer to page 98).

(16) Hiragana/Katakana key*

Press this key to switch Hiragana or Katakana for monograms (refer to page 103).

(17) Horizontal/Vertical orientation key*

Press this key to switch the horizontal or vertical orientation (refer to page 103).

NOTE:

Hiragana/Katakana keys (16) and Horizontal/Vertical orientation keys (17) are displayed only when Marumoji (7 mm) is selected.

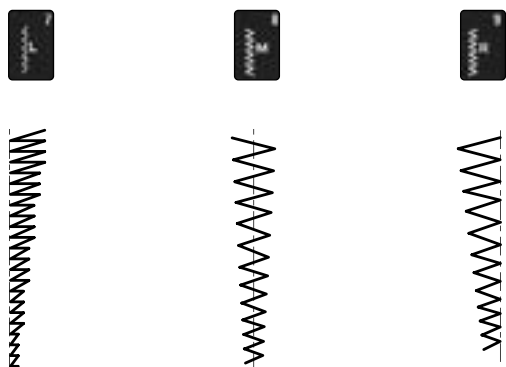
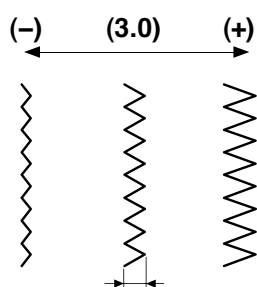
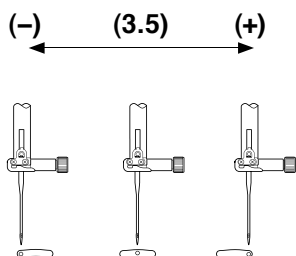
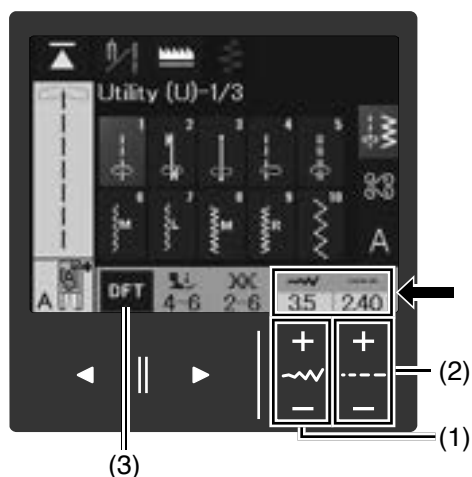

Manual Stitch Settings

You can alter the stitch width, needle drop position of the straight stitches and stitch length.

Press the “+” or “-” key to change the setting. Press the default key to recover the original stitch setting.

- (1) Stitch width adjustment keys
- (2) Stitch length adjustment keys
- (3) Default key

Altering needle drop position (straight stitches)

Press the stitch width adjustment keys to move the needle drop position.

Press the “+” key to move the needle drop position to the right.

Press the “-” key to move the needle drop position to the left.

NOTE:

The adjustable range for patterns U1-U5 is 0.0 to 7.0.

Altering stitch width (zigzag stitches)

Press stitch width adjustment keys to change the stitch width.

Press the “+” key to increase the stitch width.

Press the “-” key to decrease the stitch width.

NOTE:

The adjustable range for patterns U6-U9 is 0.0 to 7.0.

The letter beside the stitch image denotes the baseline of the needle drop position.

L: Left

When you change the stitch width, the right needle drop position will change.

M: Middle (center)

The stitch width changes symmetrically

R: Right

When you change the stitch width, the left needle drop position will change.

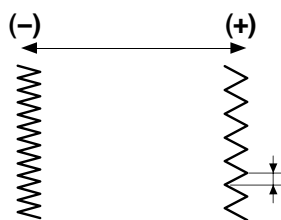
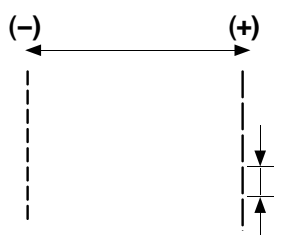

Altering stitch length

Press the stitch length adjustment keys to change the stitch length.

Press the “+” key to increase the stitch length.

Press the “-” key to decrease the stitch length.

NOTE:

- The adjustable range for patterns U1 and U4 is 0.00 to 5.00.
- The adjustable range for patterns U2 and U3 is 1.00 to 5.00.
- The adjustable range for patterns U5-U7 is 1.00 to 4.00.
- The adjustable range for patterns U8-U10 is 0.20 to 5.00.

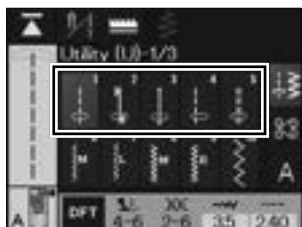

Straight Stitches

Patterns U1 to U5 are straight stitches for seaming. Press the pattern selection key for the desired stitch.

(1)



(2)



(3)

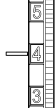

(4)

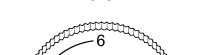

Machine settings

- | | |
|---------------------|---------------|
| (1) Stitch pattern: | U1 |
| (2) Presser foot: | Zigzag foot A |
| (3) Thread tension: | 2-6 |
| (4) Foot pressure: | 4-6 |

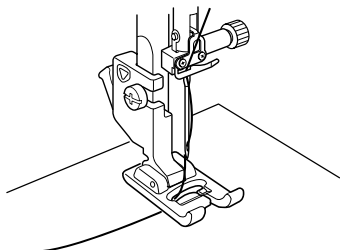
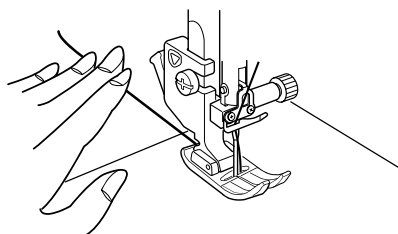

Starting to sew

Place the fabric next to the seam guide line on the needle plate. Lower the needle to the point where you want to start.

Pull the needle thread towards the rear and lower the foot.

NOTE:

Pull the needle thread to the left when using satin stitch foot F or automatic buttonhole foot R.

1.

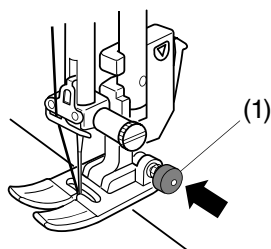

2.

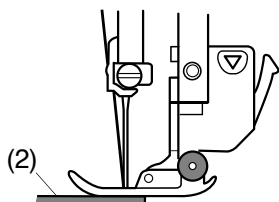

Sewing from the Edge of Thick Fabric

The black button on the zigzag foot locks the foot in the horizontal position.

This is helpful when you start sewing from extreme edge of thick fabrics or sewing across a hem.

1. Lower the needle into the fabric at the point where you wish to start sewing.

2. Lower the foot while pushing the black button in. The foot is locked in the horizontal position to avoid slipping.

- (1) Black button
- (2) Thick fabrics

1. 2. 3.

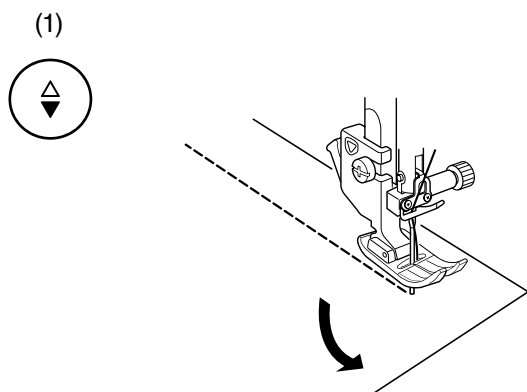

Changing Sewing Direction

1. Stop the machine and raise the presser foot lifter.
2. Pivot the fabric around the needle to change the sewing direction as desired.
3. Lower the presser foot lifter and start sewing in a new direction.

NOTE:

Lower the needle by pressing needle up/down button if the needle stop position is set at the up position.

(1) Needle up/down button

1. 2.

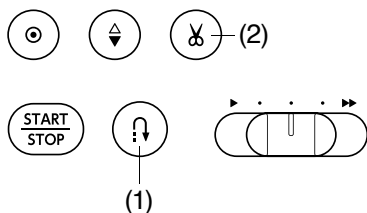

3.

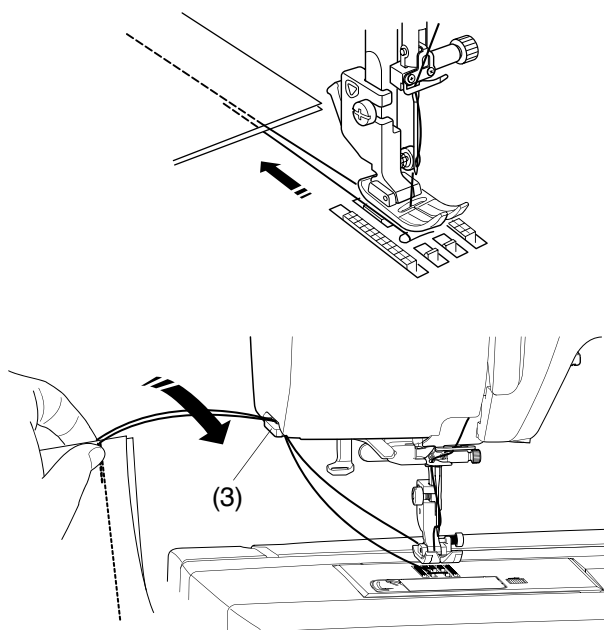

Securing Seams

1. For fastening the ends of seams, press the reverse button and sew several reverse stitches.

The machine sews in reverse as long as you press and hold the reverse button.

(1) Reverse button

2. To cut the threads after finishing sewing, press the thread cutter button.

(2) Thread cutter button

NOTE:

After cutting the thread, you can start sewing without drawing up the bobbin thread.

3. To use the thread cutter on the face cover, remove the fabric and draw it to the back.

Pull the threads up and slip them between the thread cutter and face cover from behind.

Pull the threads toward you to cut.

(3) Thread cutter

NOTE:

Use the thread cutter on the face cover to cut specialized, #30 or thicker threads if the auto thread cutter does not work well.

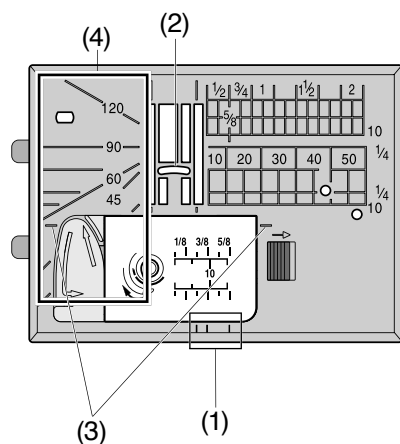

Needle Plate Guides

The seam guides are marked on the needle plate and hook cover plate.

The seam guides for 1/4", 3/8" and 5/8" are also marked on the front of the needle plate.

- (1) Seam guides on the front of the needle plate

The numbers on the needle plate indicate the distance from the center needle position in millimeters and inches.

- (2) Center needle position

The cornering guides are very useful when turning a square corner.

- (3) Cornering guide

The angle scales on the needle plate are useful for patchwork piecing (refer to page 89).

- (4) Angle scales

1. 2. 3.

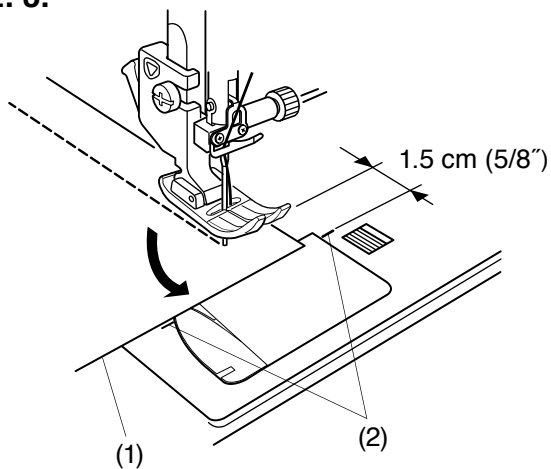

Turning a Square Corner

To maintain a 5/8" seam allowance after turning a square corner, use the cornering guide on the needle plate.

1. Stop sewing when the front edge of fabric reaches the cornering guide lines.
 - (1) Front edge of fabric
 - (2) Cornering guide
2. Raise the presser foot lifter and turn the fabric 90 degrees.
3. Lower the presser foot lifter, and begin stitching in the new direction.

NOTE:

Lower the needle by pressing needle up/down button if the needle stop position is set at up position.

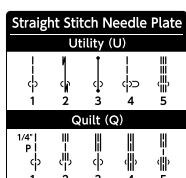
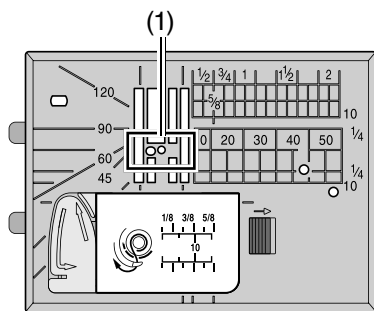

1.

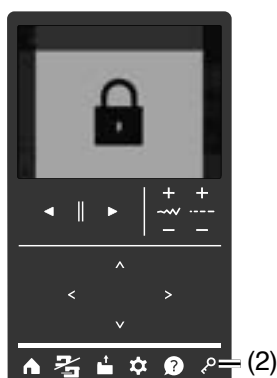

2.

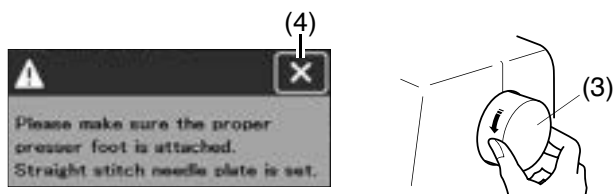

3.



Straight Stitch Needle Plate

The straight stitch needle plate has two holes where the needle enters. The straight stitch needle plate is helpful to hold and support the fabric when the needle pierces the fabric. Use the straight stitch needle plate for better results.

(1) Two holes

It is recommended to use straight stitch needle plate when sewing straight stitches (U1-U5).

1. Press the lockout key to lockout the machine.
Replace the needle plate with the straight stitch needle plate (refer to page 26).

(2) Lockout key

2. A warning message will appear.
Be sure the proper foot is attached to the machine.
Turn the handwheel slowly and be sure that the needle does not hit the needle plate.
Press the X key.

(3) Handwheel

(4) X key

3. Press the lockout key to unlock the machine.
Start sewing.

NOTE:

- The patterns not suitable for the straight stitch needle plate are grayed out and cannot be selected.
- Needle position cannot be changed with the stitch width adjustment keys when the straight stitch needle plate is attached.

Variety of Straight Stitches

U1 Straight stitch in center needle position

Machine settings

- | | |
|---------------------|---------------|
| (1) Stitch pattern: | U1 |
| (2) Presser foot: | Zigzag foot A |
| (3) Thread tension: | 2-6 |
| (4) Foot pressure: | 4-6 |

Use this stitch for seaming.

U2 Lock-a-Matic stitch

Machine settings

- | | |
|---------------------|---------------|
| (1) Stitch pattern: | U2 |
| (2) Presser foot: | Zigzag foot A |
| (3) Thread tension: | 2-6 |
| (4) Foot pressure: | 4-6 |

Use this stitch to secure the beginning and the end of a seam with backstitching.

When you reach the end of the seam, press the reverse button once.

The machine will sew four reverse stitches, four forward stitches, and then stop sewing automatically.

- (1) Reverse button

(1)



(2)



(3)

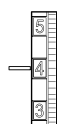

(4)

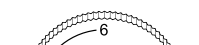

U3 Locking stitch

Machine settings

- (1) Stitch pattern: U3
- (2) Presser foot: Zigzag foot A
- (3) Thread tension: 2-6
- (4) Foot pressure: 4-6

This unique stitch is used where an invisible locking stitch is needed.

The machine will sew several locking stitches at the beginning and continue sewing forward.

When you press the reverse button at the end of the seam, the machine will sew several locking stitches in place, then stop sewing automatically.

- (1) Reverse button

(1)

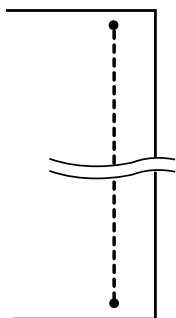

U4 Straight stitch in left needle position

Machine settings

- (1) Stitch pattern: U4
- (2) Presser foot: Zigzag foot A
- (3) Thread tension: 2-6
- (4) Foot pressure: 4-6

(1)



(2)



(3)

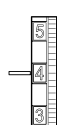

(4)

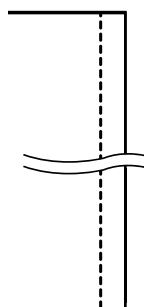
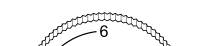

Use this stitch to seam fabrics close to the edge.